



INSTALLATION INSTRUCTION

Thermostatic Mixer Shower System

NOTICE

The instruction manual includes part lists, installation instructions, usage of thermostatic valve and suitable inlet system.

Make sure the installation is undertaken by a competent person based on the installation manual and in accordance with the requirements of the Requirements of the Water Supply (Water Fittings) Regulations 1999.

Thermostatic Mixer Shower With Slider Bar is suitable for the typical installation inlet systems as follows: Gravity system (Hot & Cold gravity system; hot gravity, cold gravity main systems; hot & cold gravity, pump assisted system); Unvented hot water system; and Combination boiler.

IMPORTANCE

Make sure the pressure and temperature supplies at the shower inlets meet below specification:

Maximum hot water temperature : 75°C

Minimum recommended hot water temperature: 60°C

Maximum cold water temperature: 20°C

Minimum operating water pressure: 0.2 Bar

Maximum operating water pressure: 5 Bar

For optimum performance, the cold and hot water supplies should be at equal pressure. Where the supply is greater than 5 bar a pressure reducing valve should be fitted.

Ensure that the water temperature and the pressure at the inlet of the mixer body remain relatively constant during use.

The hot and cold water connectors in the wall should be 1/2" BSP female thread.

TYPICAL SUITABLE INSTALLATIONS

Gravity system

A cold water tank usually located in the roof space, and a hot water cylinder, frequently in the airing cupboard. This system sometimes has a pump in the circuit (see diagram below).

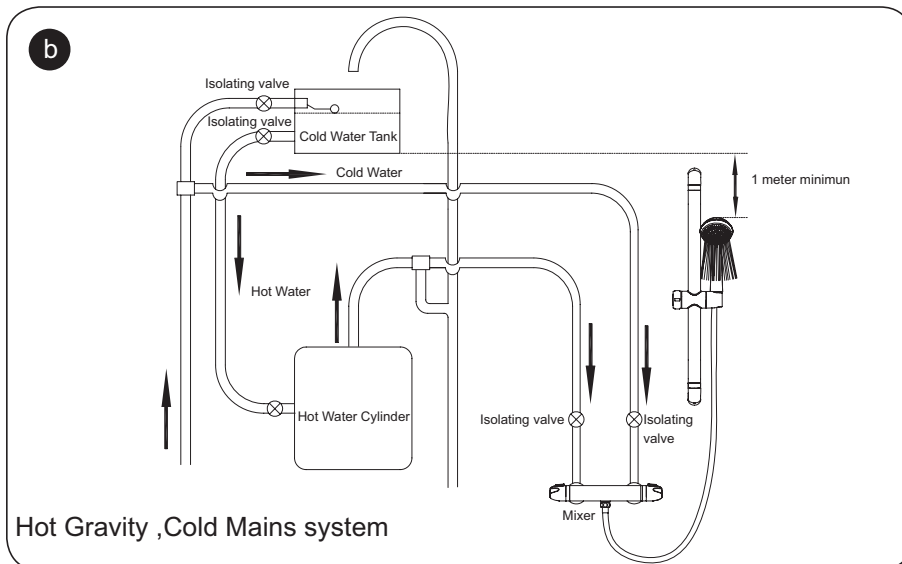
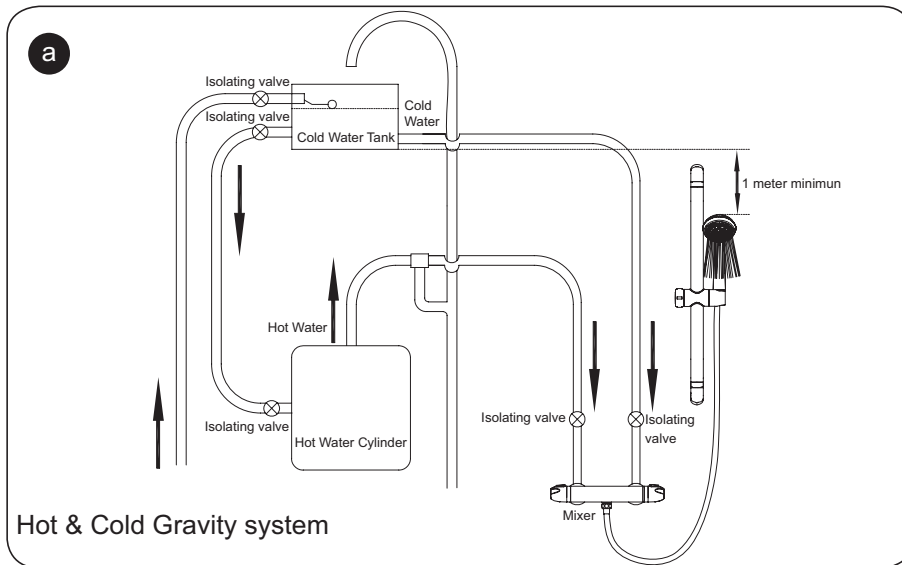

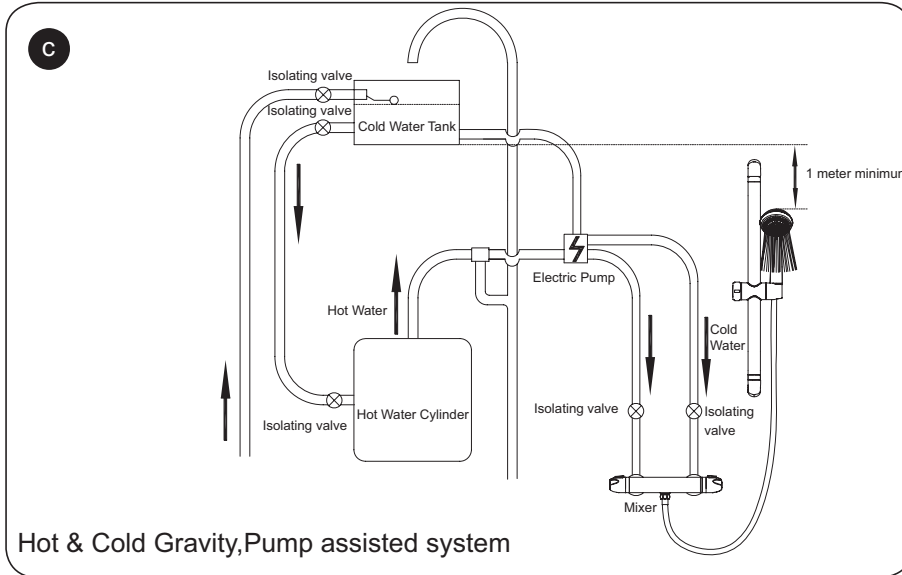

Unvented hot water system

A high-pressure cylinder of water, heated by a boiler or emersion heater, usually providing high volumes of water

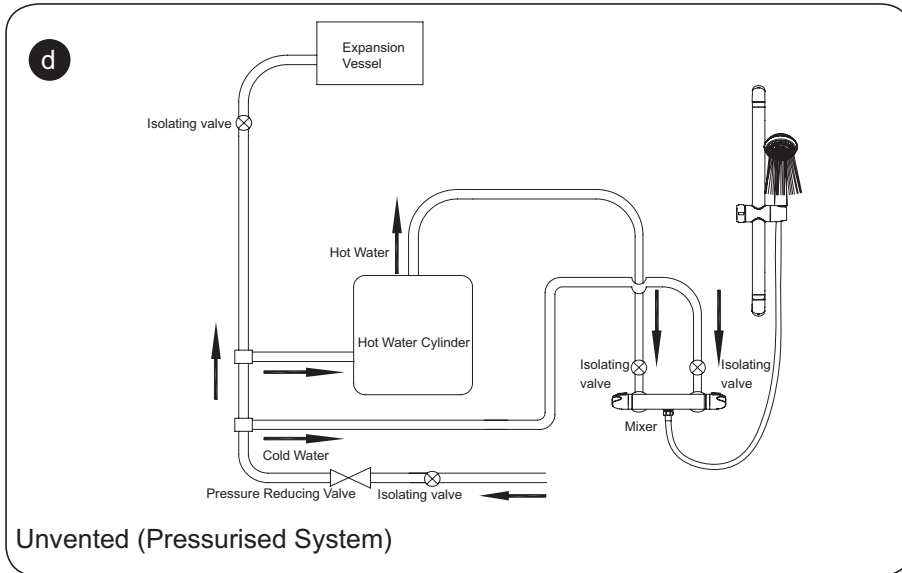

Combination boiler

These systems heat your water as you use it and usually consist of a boiler attached to a wall, often in the kitchen.

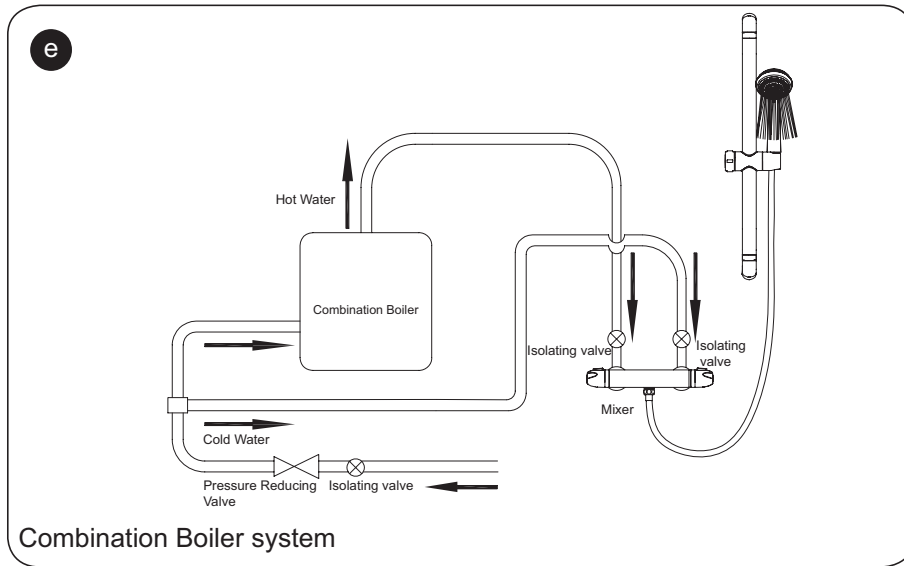

Part List

No:	Name:	Qty:
01	Tube	1
02	Fixing Bracket	1
03	Wall Plug	1
04	Fixing Ring	1
05	Tapping Screw	1
06	Sliding Rail	1
07	Slider	1
08	Diverter Valve	1
09	S-Elbow	2
10	Flange Cover	2
11	Filter Washer	2
12	Mixer Body	1
13	Flexible Hose	1
14	Hand Shower	1
15	Shower Head	1
16	Sealed Washer	3
17	Wall fixing ring	1

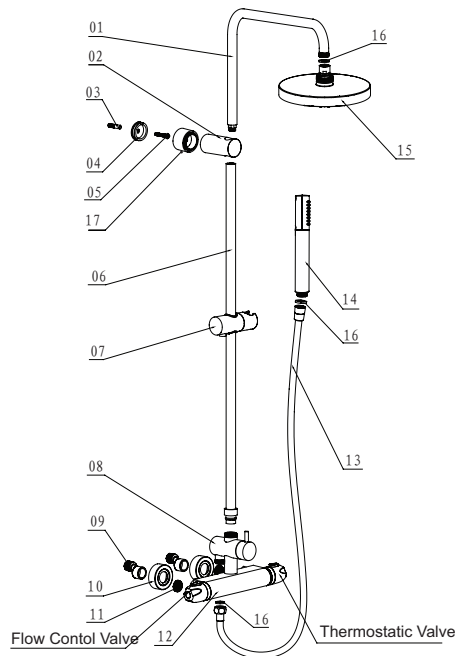

Tools Required(Not supplied)

Spanner
Phillips Screwdriver
Drill
Safety Glasses

Before You Start

1. Please ensure there are no hidden service pipes and cables where you intend to drill.
2. Debris must be cleared away from the inside service pipes before installation to ensure good functionality of water spray.
3. The wall fixings provided are suitable for solid walls only. For other types of wall use suitable alternative fixings.

Installation

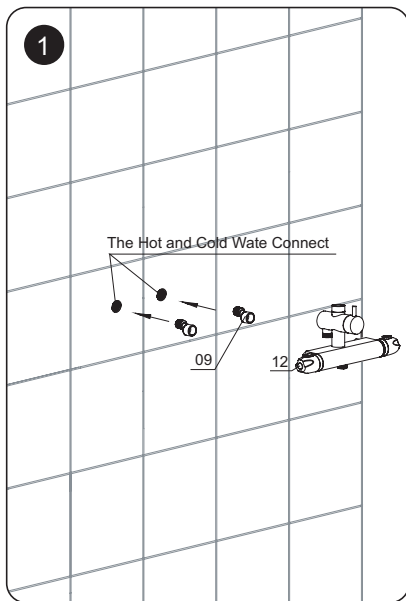

Install the s-elbows

1. Wind the small end of s-elbows (09) with PTFE tape, connect them to the hot and cold water connector. Tighten them to prevent leaking.
2. Adjust the position of the s-elbow (09) and align them to ensure they are horizontal.

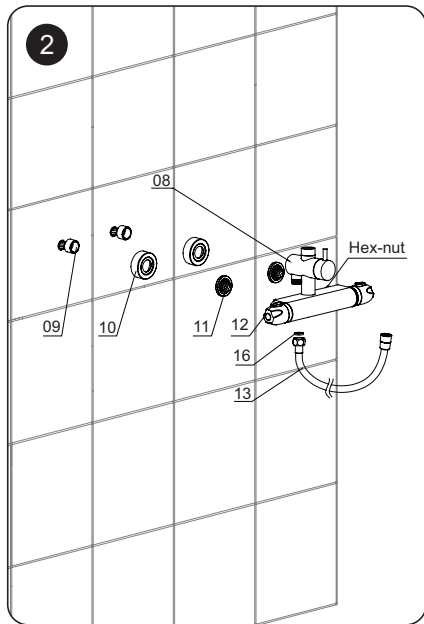

Install the mixer body

1. Connect the hex-nut of hose (13) to the outlet connector of diverter valve (08), ensuring that the sealed washer (16) is fitted between the hose (13) and connector of diverter valve (08).
2. Screw the flange covers (10) onto the big end of s-elbows (09) until the flange covers (10) butt against the wall.
3. Insert the filtrating washers (11) into the hex-nuts at the back of the mixer body (12). Connect the mixer body (12) to the big end of the s-elbows (09) using an adjustable spanner.

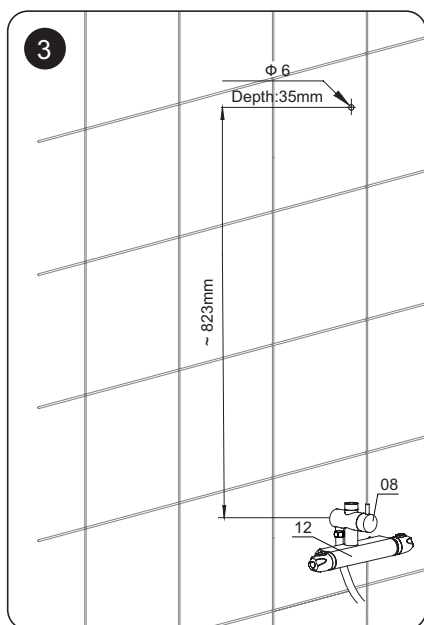

Establish the wall position for the fixing disc

1. Use a pencil to mark the position of the fixing disc on the wall.
2. Drill a 6mm diameter hole of 35mm depth on the centre point of the marked position.

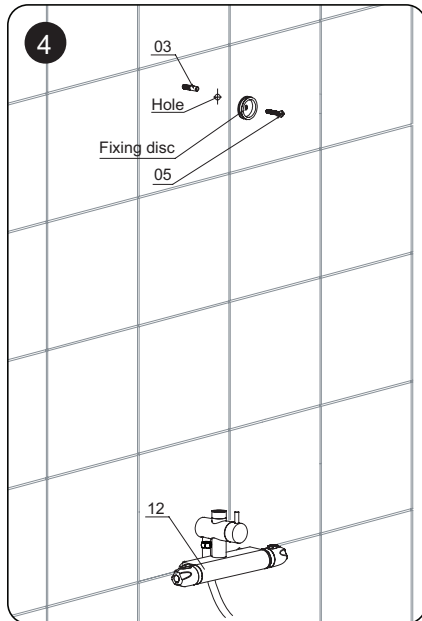

Install the fixing disc

1. Insert the wall plug (03) into the hole.
2. Remove the Fixing disc (04) from the rear of the wall fixing ring (17) by loosening retaining grub screw on the underside of wall fixing ring (17) with the hexagon key.
3. Fix the fixing disc (04) onto the wall by tightening the tapping screw (05).

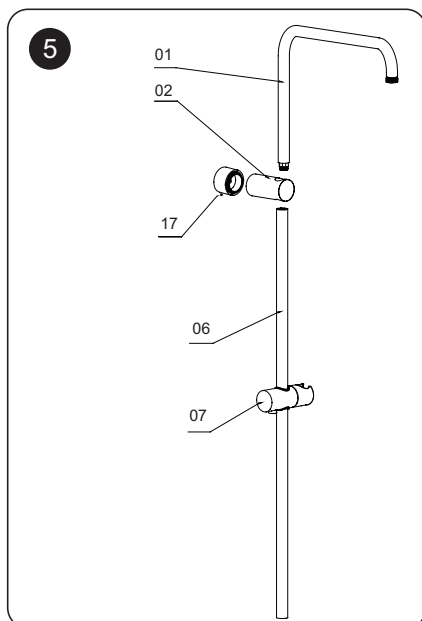

Assemble the shower riser rail

1. Remove the wall fixing ring (17) from the fixing bracket(02) by turning counterclockwise.
2. Insert the rising tube (01) into upper part of the fixing bracket (02).
3. Insert the sliding rail (06) (with female thread at the inner end) into the bottom hole of the fixing bracket (02). Secure the sliding rail (06) to the rising tube (01).
4. Tighten the cross screw (inside the fixing bracket) to fix the tube to the fixing bracket (02).

Note: Ensure the direction of the rising tube (01) is installed at the correct direction.

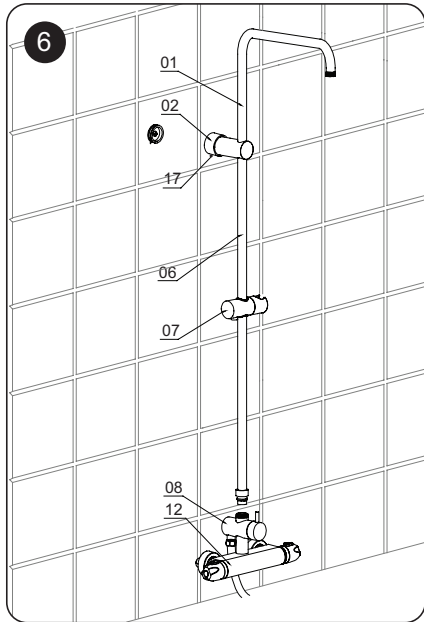

Install the shower riser rail

1. Connect the wall fixing ring (17) to the fixing bracket(02).
2. Insert the sliding rail (06) into the diverter (08). Tighten the round nut to fix the tube to the diverter valve (08).
3. Fix the wall fixing ring (17) to the fixing disc(04).Tighten the grub screw under the wall fixing ring(17).

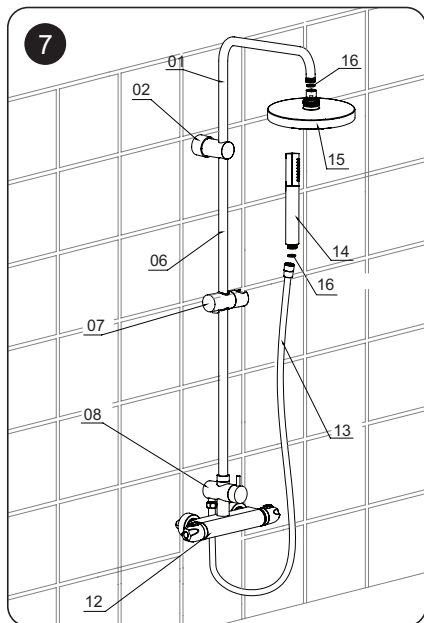

Connect shower head and hand shower

1. Connect the conical end of hose (13) to the hand shower (14), ensuring that the sealed washer (16) is fitted between the hose (13) and hand shower (14).
2. Attach the shower head (15) to the rising tube (01).
3. Press down the button on the slider (07) for adjusts the hand shower (14) to desired height.

1. Use of thermostatic valve

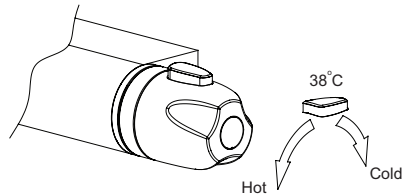

1.1 The temperature of water for a bath can be adjusted freely. The temperature button is set 38°C which effectively avoids the risk of scalding, especially on children and the elderly.

1.2 If control is turned in anti-clockwise direction, water will become hotter until the control reaches the safety button at 38°C. Press down safety button and continue to turn in anti-clockwise direction when looking for a higher temperature.

1.3 If turned in a clockwise direction, water will become cooler.

2. Use of flow control valve

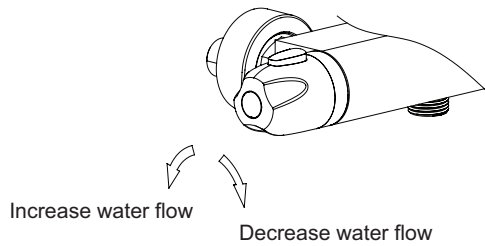

Water flow rate will be increased when turn the flow rate control in anti-clockwise direction and vice versa.

3. Use of diverter valve

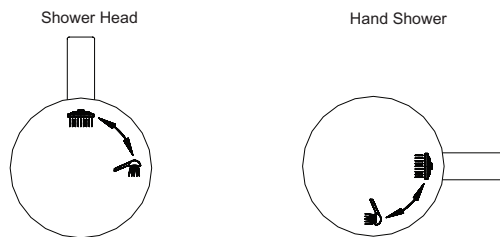

When the handle of the diverter valve is at the vertical position, water sprays from the top shower .

When the handle of the diverter valve is at horizontal position, water sprays from the hand shower .

Care & Use

- Beware of scalding from hot water. It is recommended to turn on the hand shower first.
- Always turn on the cold water first when using the bar shower.
- Do not use chemicals and other corrosive detergent to clean the shower set. Always use a non-abrasive bathroom cleaner and a soft cloth to clean it.
- Never twist or kink the hose in use because the water flow will become restricted.
- Regularly clean the shower head and hand shower to remove debris.



Watersmith UK Ltd., BA22 8RT