



C 100.6, C 110.4, C 110.4 X-TRA, C 105.6, C 120.6 X-TRA

User Manual



EN	User Manual	3 - 16
DA	Instruktionsbog	17 - 30
NO	Instruksjonsbok.....	31 - 44
SV	Instruktionsbok	45 - 58
FI	Käyttöohje.....	59 - 72
DE	Betriebsanleitung.....	73 - 87
FR	Instructions d'utilisation	88 - 103
NL	Gebruiksaanwijzing	104 - 118
IT	Istruzioni sull'uso	119 - 133
ES	Instrucciones de manejo.....	134 - 148
PT	Instruções de operação	149 - 163
EL	Οδηγίες χρήσης.....	164 - 179
TR	Kullanım Kılavuzu.....	180 - 194
CS	Návod k obsluze	195 - 208
HU	Használati útmutató.....	209 - 223
PL	Instrukcja użycia.....	224 - 238
HR	Priručnik za korisnike.....	239 - 252
SL	SL Navodila za uporabo	253 - 266
SK	Návod na používanie.....	267 - 281
LV	Lietošanas instrukcijae	282 - 295
LT	Naudojimosi instrukcija.....	296 - 309
ET	Kasutamishend	310 - 323
RU	Руководство	324 - 339
ZH	操作说明	340 - 350

Contents

1	Introduction	4
	1.1 Symbols used to mark instruction.....	4
2	Safety precautions and working techniques	4
3	Before you start using your high pressure washer	10
	3.1 Mounting of trolley handle and wheels	10
	3.2 Mounting of quick coupling	10
4	Operating your high pressure washer	11
	4.1 Connection of high pressure hose	11
	4.2 Mounting of spray lance and Click&Clean nozzles	11
	4.3 Water Connection	11
	4.4 Starting the high pressure washer	12
5	After using the pressure washer	12
	5.1 Stopping the high pressure washer	12
6	Maintenance	13
7	Troubleshooting	13
8	Warranty Conditions	14
9	Main technical Data	15
10	Declaration of Conformity	16

1 Introduction

1.1 Symbols used to mark instruction

All pictograms attached to the high pressure washer and its components are shown and explained in this manual.



Safety instructions marked with this symbol must be observed to prevent personal injury or serious damage to property.



Caution where there is a risk of damaging the machine or its individual components.



This symbol indicates tips and instructions to simplify work and to ensure a safe operation of the high pressure washer.

2 Safety precautions and working techniques



Before starting up your machine for the first time, this instruction manual must be read through carefully. Save the instructions for later use.



WARNING!

- Inhalation of aerosols can be hazardous to health. Where applicable use a device in order to avoid or reduce aerosols production, e.g., a shield covering the nozzle. For protection against aerosols use a respiratory mask of class FFP 2 or higher.
- The high water pressure generated by the machine and the power connection are particular sources of danger.
- Children should be supervised to ensure that they do not play with the machine.
- Before starting up your machine please check it carefully for any defects. If you find any, do not start up your machine, contact your Nilfisk distributor. The insulation of the electric cable should be faultless and without any cracks. If the electric cable is damaged, an authorized Nilfisk distributor should replace it.
- The operator and anyone in the immediate vicinity of the site of cleaning should take action to protect themselves from being struck by debris dislodged during operation.
- Always unplug the power plug before cleaning or maintenance and when replacing parts or converting

the machine to another function.

- Observe the national safety regulations issued, for example, by the employers liability insurance association, social security institutions, occupational safety and health authorities or other organizations.



Accessories and spare parts

- To ensure the machine safety only use original spare parts from Nilfisk or approved by Nilfisk.
- High pressure hoses, fittings and couplings are important for the safety of the machine. Only use hoses, fittings and couplings recommended by Nilfisk.



Physical, sensory or mental conditions

- This machine is not intended for use by persons (including children) with reduced physical, sensory or mental capabilities or lack of experience and knowledge.
- Anyone who has consumed alcohol, medicines or drugs affecting their ability to react must not operate the machine.



Applications

This machine has been developed for domestic use such as:

- Car, motorbike, boat, caravan, trailer, patio/drive/flagstones, woodwork, brickwork, barbecue, garden furniture, lawn mower.

Any other use is considered as improper use. Nilfisk accepts no liability for any damage resulting from such use. The risk for such use is borne solely by the user. Proper use also includes proper operation, servicing and repairs as specified in this instruction.

Clothing and equipment

Always take action to protect yourself when operating the machine.

- Wear shoes with non-slip soles.
- Wear goggles, ear protection and protective clothes during operation.



Transporting the high pressure washer

- When transporting the machine in or on a vehicle, it must be secured, e.g. with straps, so that it cannot slip or tip over.
- Nilfisk recommends that the machine is positioned horizontally on the backside, when transported in or on a vehicle.



Detergents

- This machine has been designed for use with cleaning agents supplied or recommended by Nilfisk. The use of other cleaning agents or chemicals may adversely affect the function of the machine.



Before starting the work Inspecting the machine

- Do not use the machine if a supply cord or important parts of the machine are damaged, e.g., safety device, high pressure hose, and spray handle and spray attachments.
- The trigger of the spray handle must move easily and automatically return to its starting position when released.
- Always keep high pressure hose and spray attachment in good condition (clean, moving easily) and correctly assembled.

Electrical connection



WARNING!

Minimize the risk for electrical shock:

- Voltage and frequency of the machine (see rating plate) must match the voltage of and frequency of the mains supply.
- Only connect the machine to electrical installation made by a certified electrician and comply with IEC 60364-1.
- It is recommended that the electrical supply to the machine should include a residual current device that will interrupt the supply if the leakage current to earth

EN

DA

NO

SV

FI

DE

FR

NL

IT

ES

PT

EL

TR

CS

HU

PL

HR

SL

SK

LV

LT

ET

RU

ZH

EN

DA

NO

SV

FI

DE

FR

NL

IT

ES

PT

EL

TR

CS

HU

PL

HR

SL

SK

LV

LT

ET

RU

ZH

exceeds 30 mA for 30 ms.

- Inadequate extension cables can be dangerous. If an extension cable is used, it shall be suitable for outdoor use, and the connection has to be kept dry and off the ground
- Nilfisk recommends use of an extension cable drum when cable extension is needed which keeps the socket at least 60 mm above the ground.
- Cables on extension cable drums should always be completely unwound to prevent overheating. Extension cables must comply with the below-mentioned requirements for length and cable dimensions:

1.0 mm ²	Max.	12.5 m
1.5 mm ²	Max.	20.0 m
2.5 mm ²	Max.	30.0 m
- If the electric cable is damaged, it must be replaced by an authorized Nilfisk distributor or similar qualified person in order to avoid a hazard.

Water connection



- This high pressure washer is only allowed to be connected with the drinking water mains, when an appropriate backflow preventer has been installed, Type BA according to EN 60335-2-79.
- The backflow preventer can be ordered under number 106411177.
- As soon as drinking water has flown through the backflow preventer, it is no longer regarded as drinking water.
- Operation by suction (e.g. a rainwater vessel) is carried out without a backflow preventer – see “**Connecting to a pressureless water supply**”.



IMPORTANT !

- Only use water without any impurities.
- If there is a risk of running sands in the inlet water (i.e. from your own well), an additional filter should be mounted.

During work



WARNING!

- Never use the machine in an environment where there could be a danger of explosions. If any doubt arises contact the local authorities.
- It is not allowed to clean asbestos-containing surfaces with high pressure.
- Never draw in fluids containing solvents (e.g., gasoline, heating oil, paint thinner or acetone) These substances damage the materials used in the machine. Their spray is highly combustible, explosive and poisonous.
- Never direct the water jet at yourself, other persons, not even to clean clothing or footwear - **risk of injury**.
- Never direct the water jet at pets or other animals.
- Never direct the water jet at live electrical equipment or the machine itself - **danger of short-circuiting**.
- Hold the spray lance firmly with both hands. The spray lance is affected by a thrust of up to 16.4 N during operation.
- This high pressure washer machine must not be operated at temperatures below 0°C.
- Never start up a frozen machine. Frost damages are not covered by the guarantee!
- Always ensure firm and safe footing.
- Keep the machine as far away as possible from the object being cleaned.
- Always adjust the distance and thus the pressure of the nozzle to the surface, which is to be cleaned to avoid any damage to the surface being cleaned.
- The machine shall be operated in an upright position.
- Do not cover the machine or use it in a room without adequate ventilation.
- If the machine is left or not used for 5 minutes, it must be switched off on the start/stop switch "O" (1).

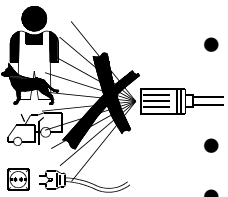

EN

DA

NO

SV

FI

DE

FR

NL

IT

ES

PT

EL

TR

CS

HU

PL

HR

SL

SK

LV

LT

ET

RU

ZH

After finishing the work



WARNING!

- Always switch off the machine and unplug the power plug from the socket after work and when leaving the machine unattended.
- Disconnect water inlet hose between machine and water supply.
- Wind up electrical cable and high pressure hose – to avoid damage of cable, plug, high pressure hose and fittings.
- Always empty pump, hose and accessories of water after use of the machine and prior to storing.

Maintenance and repairs



WARNING!

- Always disconnect the electrical plug from the socket prior to maintenance, cleaning and repair.
- Any repair should always be made in Nilfisk authorized workshop with original Nilfisk spare parts.
- Do not attempt any maintenance not described in the instructions.
- If the machine refuses to start, stops, pulsates, pressure fluctuates, motor busses, fuse blows or no water comes out, check the trouble shooting diagram in these instructions. In case other problems occur, please contact your local Nilfisk distributor.



Recycling the high pressure washer

Make the old machine unusable immediately.

- Unplug the machine.
- Cut the electric cable.

Do not discard electrical appliances with household waste. As specified in WEEE Directive 2012/19/EC on old electrical and electronic appliances, used electrical goods must be collected separately and recycled ecologically. Contact your local authorities or your nearest dealer for further information.

EN

3 Before you start using your high pressure washer

A



See the pictorial quick reference guide – unpacking.

Illustration shows the operation elements and how to prepare your machine for use.

DA

NO

SV

FI

DE

FR

NL

IT

ES

PT

EL

TR

CS

HU

PL

HR

SL

SK

LV

LT

ET

RU

ZH

Operation elements

1. Start/stop switch
2. Water inlet with filter (2a)
3. High pressure connection
4. High pressure hose
5. Electric cable
6. Click&Clean spray lance
7. Spray handle with lock (7a)
8. Click&Clean Tornado nozzle (C 100.6, C 105.6 and C 110.4)
9. Click&Clean Tornado PR nozzle (C 120.6)
10. Click&Clean Powerspeed nozzle
11. Foam sprayer
12. Nozzle cleaning tool
13. Accessory storage
14. Model tag
15. Trolley handle
16. Holder for hose/electric cable (C 100.6-6, C 110.4 and C 120.6)
17. Hexagon key for handle and bracket mounting
18. Wheel brackets
19. Wheels
20. Wheel caps

3.1 Mounting of trolley handle and wheels

Mounting of trolley handle

Only applicable for models with trolley handle and wheels (C 100.6-6, C 110.4, C 110.4 X-TRA and C 120.6 X-TRA)

- A1** Place the trolley handle (15) on the machine.
- A2** Secure the handle by mounting the 2 screws using the enclosed hexagon key (17).

Mounting of wheel brackets

- A3** Place the wheel brackets (18) on the machine.
- A4** Secure the wheel brackets by mounting the 2 screws, using the enclosed hexagon key.
- A5** Place the wheels (19) on the wheel axel – push into position – you should hear a click when the wheels are in correct position.
- A6** Secure the wheels by mounting the wheel caps (20) – you should hear a click when the wheel caps are in correct position and the wheel is secured.

3.2 Mounting of quick coupling

- A7** When mounting the quick coupling for the first time, check that the factory fitted filter (2a) is positioned in the water inlet pipe.
- A8** Screw the quick coupling tight on to the water inlet (2).

IMPORTANT!



The inlet filter must always be fitted in the water inlet pipe to filter out sand, limestone and other impurities as these will damage the pump valves. The filter is factory fitted. If the filter is removed this will invalidate the guarantee.

4 Operating your high pressure washer

B



See the pictorial quick reference guide – operating your high pressure washer.

4.1 Connection of high pressure hose

- B1** Attach the high pressure hose (4) to the spray handle (7). Detach the high pressure hose by pressing the pawl (A).
- B2** Mount the high pressure hose on the outlet (3).

4.2 Mounting of spray lance and Click&Clean nozzles

- B3** Push the spray lance (6) into the spray handle and screw it on.



NOTE!

The spray lance has a built-in low pressure nozzle that can be used for flushing away dirt.

- B4** When attaching the nozzles (8, 9, 10), press the nozzles into the spray lance.



IMPORTANT!

When attaching the click & Clean nozzles, the pawl on the side of the spray lance should come out again. The nozzle should stay in position when pulling it.

- B5** Push the foam sprayer (11) into the spray lance.



NOTE!

The foam sprayer features a swivel lock, which must be positioned in the hole in the Click & Clean spray lance. Press the pawl to detach the Click & clean nozzles and the foam sprayer.



IMPORTANT!

Before starting the cleaning job, check that the machine is in an upright position and placed on an even surface. Do not place the machine in high grass!

4.3 Water Connection



IMPORTANT!

Connecting to pressurized water supply

The inlet water max. pressure is 1 MPa/10 bar and the max. temperature is 40°C – see rating plate. An ordinary ½” garden hose of min. 10 m and max. 25 m will be suitable.

- B6** Check that the filter is fitted in the water inlet pipe and that it is not clogged up.
- B7** Connect the water hose to the water supply by means of the quick connector. Turn on the water.



Connection to the drinking water mains according to national and local regulations.



Let the water run through the water hose before connecting it to the machine to prevent sand and dirt from penetrating the machine.

- B8** Turn off the water and connect the water hose by means of the quick coupling to the water inlet.



Connecting to pressure less water supply

The machine can also operate in suction mode, meaning that you can connect the machine to e.g. rainwater vessels, rivers, lakes and cisterns etc. When taking in water from non drinking water mains the backflow preventer is not needed.

EN

DA

NO

SV

FI

DE

FR

NL

IT

ES

PT

EL

TR

CS

HU

PL

HR

SL

SK

LV

LT

ET

RU

ZH

EN



When connecting the machine to operate from pressure less water supplies – always use additional filtering to secure that impurities are not sucked in. Hose length should be max. 3 meter and of minimum ½".

DA

NO

SV

FI

DE

FR

NL

IT

ES

PT

EL

TR

CS

HU

PL

HR

SL

SK

LV

LT

ET

RU

ZH

To meet these requirements, Nilfisk recommends that you use the original Nilfisk suction hose kit.

The Machine is designed for suction up to 50 cm above water surface.

- Position the machine at max. 0.5 meter above water surface. Detach the high pressure hose from the outlet.
- Ensure that the inlet filter is in position and attach the suction hose kit, secure tight connection to the inlet.
- Turn on the machine, pressing the start/stop switch (1) into position "I".
- Wait until a steady jet exits the outlet.
- Switch off the machine and attach high pressure hose (4), spray handle, lance and nozzle.
- Start the machine again and activate the spray handle.

4.4 Starting the high pressure washer



IMPORTANT!

Connecting to mains power supply

The voltage and frequency of the machine (see model tag (14)) must match the voltage and frequency of the power supply.

B9 Insert the power plug into power supply socket.

B10 Turn on the water.

B11 Release the trigger lock (7a). Remember to unplug, turn off the high pressure washer and lock the trigger, when leaving the high pressure washer unattended

B12 Activate the trigger of the spray handle and let the water run until all air has escaped from the water hose.

B13 Turn on the machine, pressing the start/stop switch into position "I".

B14 Activate the trigger of the spray handle. When releasing the trigger of the spray handle, the machine automatically stops. The machine will start again when you reactivate the trigger of the spray handle.



5 After using the pressure washer



See the pictorial quick reference guide – storing the high pressure washer.



The high pressure washer should be stored in a frost free room! Should the machine by a mistake be frozen, it will be necessary to check it for damages.

5.1 Stopping the high pressure washer

C1 Shut off the water supply and activate the trigger of the spray handle and let the machine run until no more water runs out of the nozzle. This will wash out water hose, high pressure hose, spray lance and nozzles.

C2 Stop the machine, pressing the start/stop switch into position "0".

C3 Unplug the machine from the power supply socket and wind up the electrical cable (5) and place it on the holder (16).

C4 Rinse the spray lance, nozzles and the foam sprayer after use.

C5 Place spray handle, lance, nozzles, foam sprayer and other accessories in the holders on the high pressure washer.

6 Maintenance

D



See the pictorial quick reference guide - maintenance.



To ensure a long and problem free working life of the high pressure washer, please take the following advices:

- Wash out water hose, high pressure hose, spray lance and accessory before mounting
- Clean the connectors of dust and sand
- Rinse the detergent bottle and the detergent nozzle
- Clean the nozzle
- Keep the water inlet filter clean and unclogged

Cleaning of the water inlet filter

D1 Clean the water inlet filter regularly once a month or more frequently according to use. Carefully loosen the filter with a screwdriver and clean it. Check that it is intact before remounting it.

Cleaning of nozzle

A clogging up in the nozzle causes a pump pressure which is too high, why cleaning is required immediately.



IMPORTANT!

The nozzle cleaning tool (12) should only be used when the nozzle is detached and the machine is stopped!

D2 Stop the machine and disconnect the nozzle. Clean the nozzle.

D3 Flush the nozzle backwards with water.

Cleaning of machine vents

D4 The machine should be kept clean so as to let cooling air pass freely through the machine vents.

Greasing of O-rings

D5 To ensure an easy connection and that O-rings do not dry up the couplings should be greased regularly.

7 Troubleshooting

To avoid unnecessary disappointments, you should check the following before contacting the Nilfisk service organization.

Symptom	Cause	Recommended action
Machine refuses to star	Machine not plugged in Defective socket Fuse has blown Defective extension cable	Plug in machine Try another socket. Replace fuse. Switch off other machines. Try without the extension cable.
Fluctuating pressure	Pump sucking Valves dirty, worn out or stuck Pump seals worn out	Check that hoses and connections are airtight. Clean and replace or refer to local Nilfisk-distributor. Clean and replace or refer to local Nilfisk-distributor.

EN

DA

NO

SV

FI

DE

FR

NL

IT

ES

PT

EL

TR

CS

HU

PL

HR

SL

SK

LV

LT

ET

RU

ZH

Symptom	Cause	Recommended action
Machine stops	Fuse has blown Incorrect mains voltage Thermal sensor activated Nozzle partially blocked	Replace fuse. Switch off other machines. Check that the mains voltage corresponds to specification on the model tag. Leave the washer for 5 minutes to cool down. Clean the nozzle (see section 6.2)
Fuse blows	Fuse too small	Change to an installation higher than the amp. consumption of the machine. You may try without the extension cable.
Machine pulsating	Air in inlet hose/pump Inadequate supply of mains water Nozzle partially blocked Water filter blocked Hose kinked	Allow machine to run with open trigger until regular working pressure resumes. Check that the water supply corresponds to specifications required (see model tag) NB! Avoid using long, thin hoses (min. 1/2") Clean the nozzle (see section 6.2) Clean the filter (see section 6.1) Straighten out hose.
Machine often starts and stops by itself	Pump/spray handle is leaking	Contact your nearest Nilfisk Service Centre.
Machine starts, but no water comes out	Pump/hoses or accessory frozen No water supply Water filter blocked Nozzle blocked	Wait for pump/hoses or accessory to thaw. Connect inlet water. Clean the filter (see section 6.1) Clean the nozzle (see section 6.2)

In case problems other than the above occur, please contact your local Nilfisk distributor. Local Nilfisk distributors are listed on the back cover of this instruction.

Customer Service at Penrith – 01768 868995

8 Warranty Conditions

Nilfisk guarantees high pressure washers for domestic use for 2 years. If your high pressure washer or accessories are handed in for repair, a copy of the receipt must be enclosed.

Guarantee repairs are being made on the following conditions:

- that defects are attributable to flaws or defects in materials or workmanship. (wear and tear as well as misuse are not covered by the guarantee).
- that the directions of this instruction manual have been thoroughly observed.
- that repair has not been carried out or attempted by other than Nilfisk-trained service staff.
- that only original accessories have been applied.
- that the product has not been exposed to abuse such as knocks, bumps or frost.
- that only water without any impurities has been used.
- that the high pressure washer has not been used for rental nor used commercially in any other way.

Repairs under this guarantee include replacement of defective parts, exclusive of packing and postage/carriage. Besides, we refer to your national law of sale.

The machine should be forwarded to one of the service centres of the Nilfisk organisation with description/specification of the fault.

Repairs not covered by the guarantee conditions will be invoiced. (I.e. malfunctions due to **Causes** mentioned in section **Troubleshooting Chart** of the instruction manual).

9 Main technical Data

Type		C 100.6		C 105.6	C 110.4	C 120.6	
Electric specifications							
Rated voltage	V	220-240	120	220-240	220-240	220-240	120
Rated frequency	Hz	50/60	60	50/60	50/60	50/60	60
Rated power consumption	kW	1.3		1.4	1.4	1.4	
Current	A	5.7	11	6.1	6.1	6.1	12
Protection class	Class I/ Class II	Class II		Class II	Class II	Class II	
Protection degree	IP xx	IPX5		IPX5	IPX5	IPX5	
Hydraulic specifications							
Rated pressure	MPa/bar	7/70	7/70	7.5/75	8/80	8.5/85	8/80
Max. pressure	MPa/bar	10/100	9/90	10.5/105	10/110	12/120	10/100
Rated water flow	l/min/l/h	5.3/320		5.2/310	5.2/310	5.2/310	5.3/320
Max. water flow	l/min/l/h	7.3/440		7.3/440	7.3/440	7.3/440	
Max. water inlet pressure	Mpa/bar	1/10		1/10	1/10	1/10	
Max. water inlet temperature	°C	40		40	40	40	
Max. water inlet temp. suction mode	°C	20		20	20	20	
Weight							
Weight	kg	5.1 (6.1)*		5.5	6.1(6.5)**	6.7	
Hand-arm vibration according to ISO 5349-1: Standard nozzle							
Hand-arm vibration according to ISO 5349-1: Standard nozzle	m/s ²	< 2.5 ±1		< 2.5 ±1	< 2.5 ±1	< 2.5 ±1	
Sound pressure level L _{pA} in accordance with ISO 3744	dB(A)	74 ±3		74 ±3	74 ±3	74 ±3	
Guaranteed sound power level L _{WA} in accordance with 2000/14/EC	dB(A)	90		90	90	90	

We reserve the right to make alterations.

* C 100.6-6, ** C 110.4 X-TRA

EN

DA

NO

SV

FI

DE

FR

NL

IT

ES

PT

EL

TR

CS

HU

PL

HR

SL

SK

LV

LT

ET

RU

ZH

EN

10 Declaration of Conformity

DA

We,

NO

Nilfisk-Advance A/S
Sognevej 1
DK-2605 Broendby
DENMARK

SV

FI

Hereby solely declare, that the product:

DE

FR

Product	Description	Type
HPW - Consumer	220 - 240 V 1~, 50/60 Hz – IP X5	Nilfisk C 100.6 / C 105.6 / C 110.4 / C 120.6 and accessory variants of above- mentioned types

NL

Is in compliance with the following standards:

IT

ES

PT

EL

TR

CS

HU

PL

Id and Version	Title
EN 60335-1:2012	Household and similar electrical appliances - Safety - Part 1: General requirements
EN 60335-2-79:2012	Household and similar electrical appliances - Safety - Part 2-79: Particular requirements for high pressure cleaners and steam cleaners
EN 55014-1:2006+ A1:2009+A2:2011	Electromagnetic compatibility - Requirements for household appliances, electric tools and similar apparatus - Part 1: Emission
EN 55014-2:1997+A1:2001 +A2:2008	Electromagnetic compatibility - Requirements for household appliances, electric tools and similar apparatus - Part 2: Immunity - Product family standard
EN 61000-3-2:2006+A1:2009 +A2:2009	Electromagnetic compatibility (EMC) - Part 3-2: Limits - Limits for harmonic current emissions (equipment input current \leq 16 A per phase)
EN 61000-3-3:2008	Electromagnetic compatibility (EMC) - Part 3-3: Limits - Limitation of voltage changes, voltage fluctuations and flicker in public low-voltage supply systems, for equipment with rated current \leq 16 A per phase and not subject to conditional connection

HR

Following the provisions of:

SL

Machinery Directive 2006/42/EC
EMC Directive 2004/108/EC
RoHS Directive 2011/65/EC

SK

Noise Emission Directive 2000/14/EC – Conformity assessment procedure according to Annex V.

Measured noise level: 74 dB; Guaranteed noise level: 90 dB

Ecodesign requirements for standby and off mode 1275/2008/EC

LT

Hadsund 01-01-2013 Anton Sørensen
GM – Technical Operations & Hadsund



ET

Place	Date	Name, Title	Signature
Hadsund	01-01-2013	Anton Sørensen GM – Technical Operations & Hadsund	

RU

ZH

A

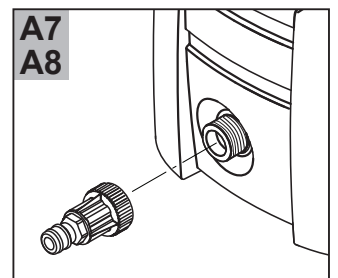
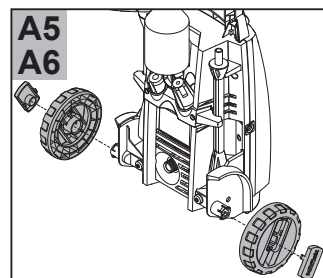
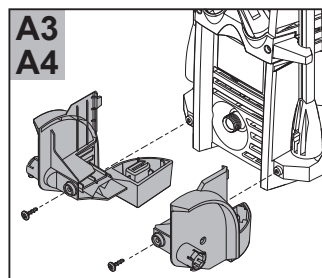
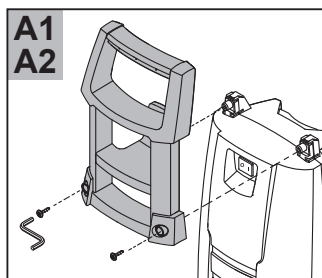
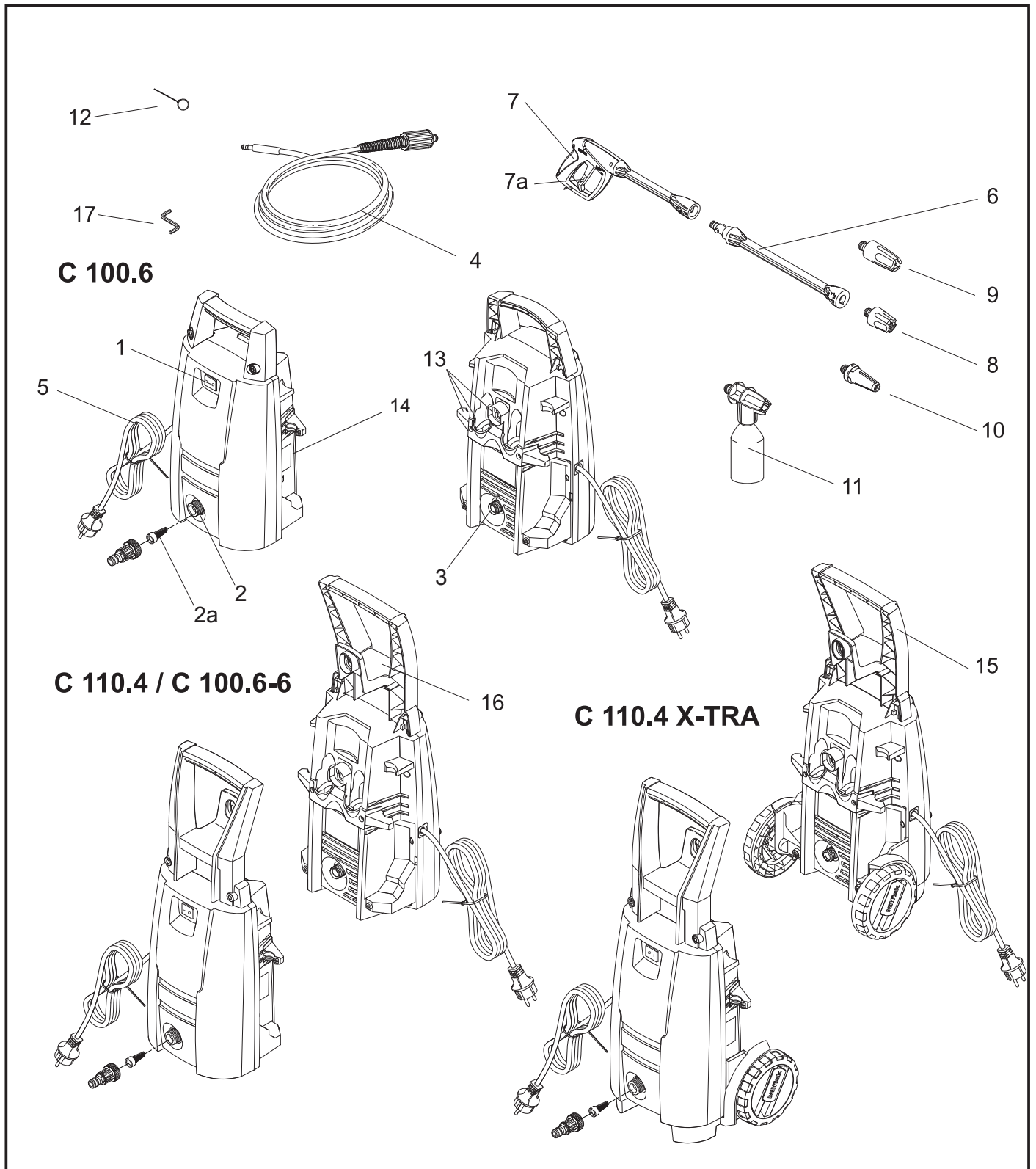
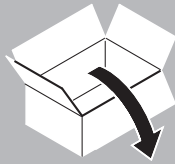

A

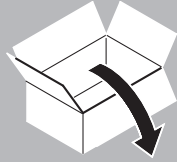

C 105.6

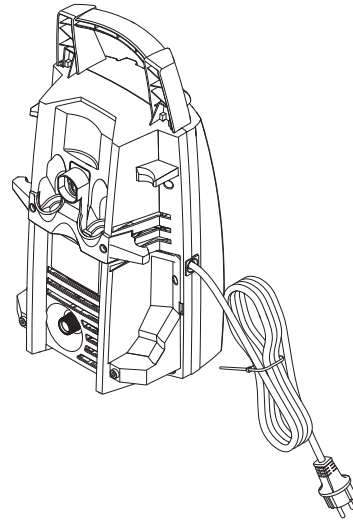
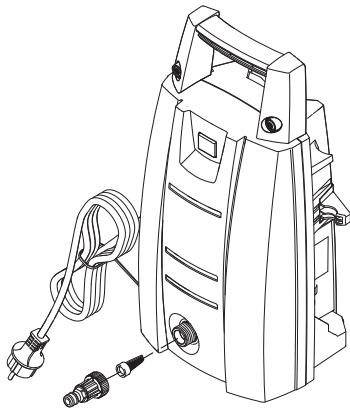

C 120.6 X-TRA

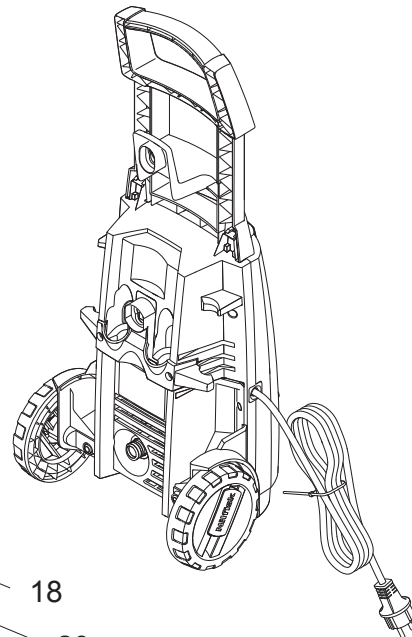
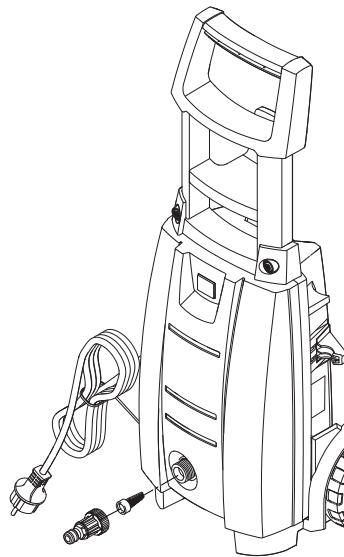

18

20

19

B

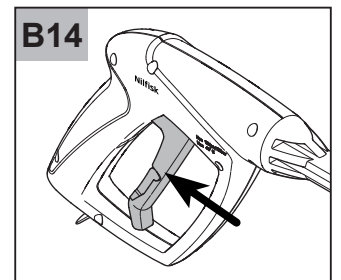
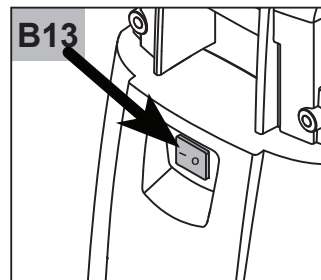
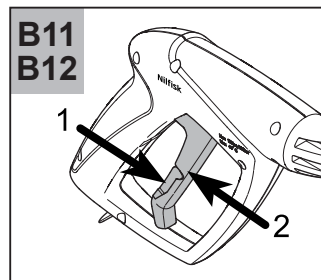
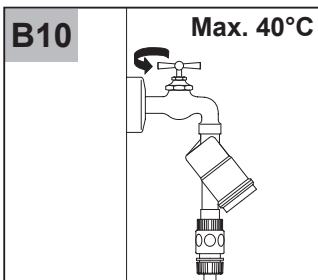
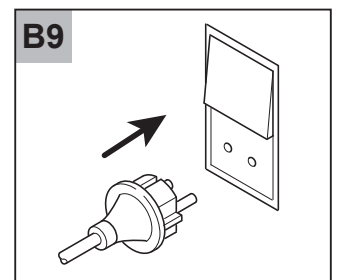
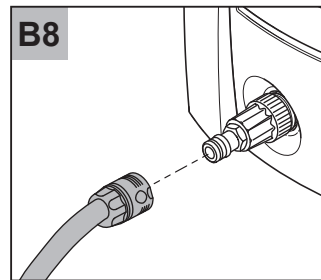
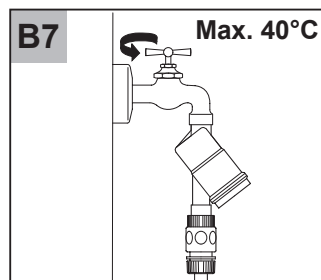
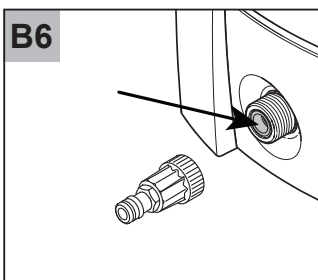
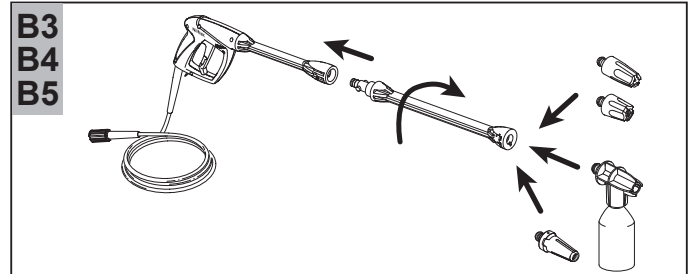
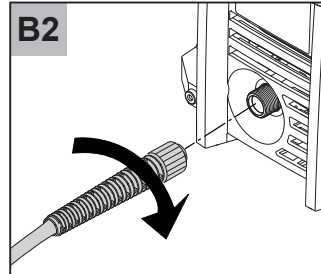
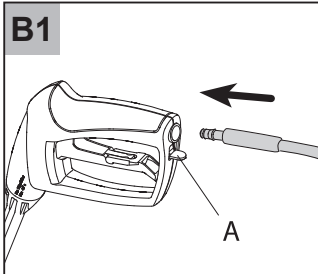

C

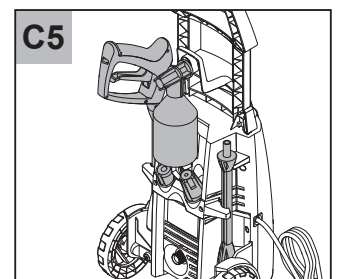
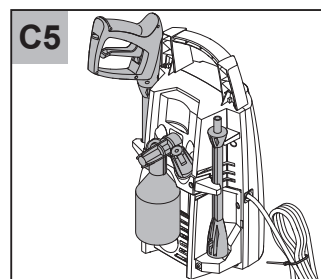
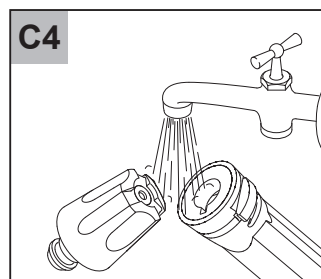
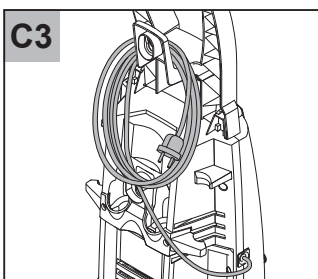
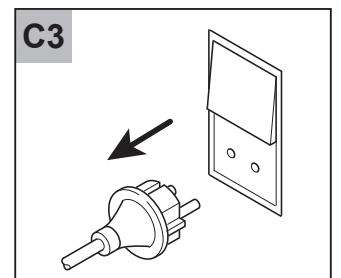
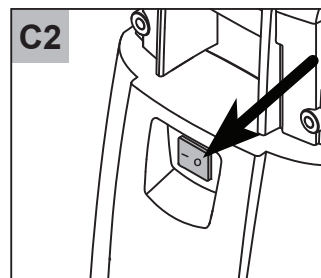
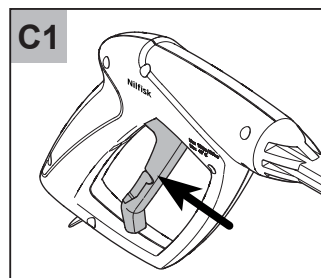
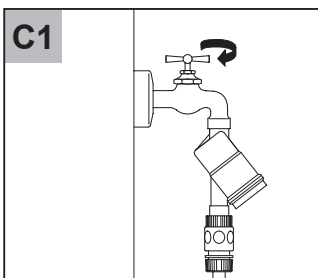
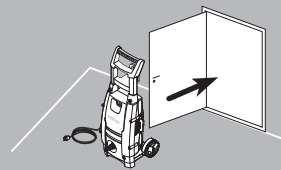

D

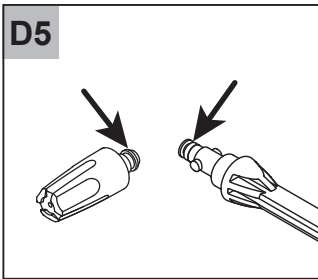
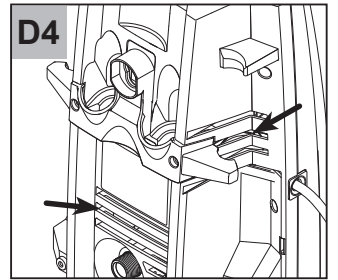
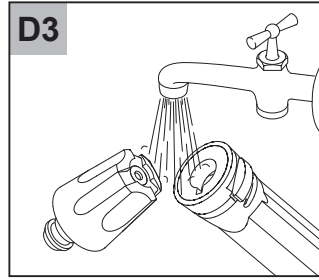
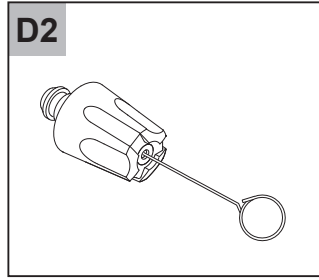
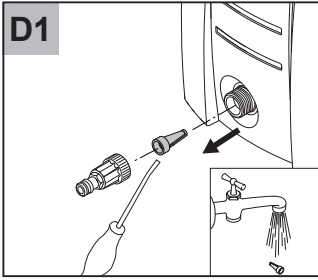

Nilfisk

<http://www.nilfisk.com>

HEAD QUARTER

DENMARK

Nilfisk-Advance Group
Sognevej 25
DK-2605 Brøndby
Tel.: (+45) 4323 8100
E-mail: mail.com@nilfisk-advance.com

SALES COMPANIES

AUSTRALIA

Nilfisk-Advance
48 Egerton St.
P.O. Box 6046
Silverwater, N.S.W. 2128
Website: www.nilfisk.com.au

AUSTRIA

Nilfisk-Advance GmbH
Metzgerstrasse 68
5101 Bergheim bei Salzburg
Website: www.nilfisk.at

BELGIUM

Nilfisk-Advance n.v.s.a.
Riverside Business Park
Boulevard Internationalelaan 55
Bâtiment C3/C4 Gebouw
Bruxelles 1070
Website: www.nilfisk.com

CHILE

Nilfisk-Advance de Chile
San Alfonso 1462
Santiago
Website: www.nilfisk.com

CHINA

Nilfisk-Advance (Suzhou)
Building 18, Suchun Industrial Estate
Suzhou Industrial Park
215021 Suzhou
Website: www.nilfisk-cs.com

CZECH REPUBLIC

Nilfisk-Advance
VGP Park Horní Počernice
Do Čertous 1/2658
193 00 Praha 9
Website: www.nilfisk.com

DENMARK

Nilfisk-Advance NORDIC A/S
Sognevej 25
2605 Brøndby
Tel.: (+45) 4323 4050
E-mail: kundeservice.dk@nilfisk.com

FINLAND

Nilfisk-Advance Oy Ab
Koskelontie 23 E
02920 Espoo
Website: www.nilfisk.fi

FRANCE

Nilfisk-Advance
26 Avenue de la Baltique
Villebon sur Yvette
91978 Courtabouef Cedex
Website: www.nilfisk.fr

GERMANY

Nilfisk-ALTO
eine Marke der Nilfisk-Advance GmbH
Guido-Oberdorfer-Straße 2-10
89287 Bellenberg
Website: www.nilfisk.de

GREECE

Nilfisk-Advance A.E.
Αναπαύσεως 29
Κορωπί Τ.Κ. 194 00
Website: www.nilfisk.gr

HOLLAND

Nilfisk-Advance
Versterkerstraat 5
1322 AN Almere
Website: www.nilfisk.nl

HUNGARY

Nilfisk-Advance Kereskedelmi Kft.
II. Rákóczi Ferenc út 10
2310 Szigetszentmiklos-Lakihegy
Website: www.nilfisk.hu

INDIA

Nilfisk-Advance India Limited
Pramukh Plaza, 'B' Wing, 4th floor, Unit No. 403
Cardinal Gracious Road, Chakala
Andheri (East) Mumbai 400 099
Website: www.nilfisk.com

IRELAND

Nilfisk-Advance
1 Stokes Place
St. Stephen's Green
Dublin 2
Website: www.nilfisk.com

ITALY

Nilfisk-Advance SpA
Strada Comunale della Braglia, 18
26862 Guardamiglio (LO)
Website: www.nilfisk.it

JAPAN

Nilfisk-Advance Inc.
1-6-6 Kita-shinyokohama, Kouhoku-ku
Yokohama, 223-0059
Website: www.nilfisk.com

MALAYSIA

Nilfisk-Advance Sdn Bhd
Sd 14, Jalan KIP 11
Taman Perindustrian KIP
Sri Damansara
52200 Kuala Lumpur
Website: www.nilfisk.com

MEXICO

Nilfisk-Advance de Mexico, S. de R.L. de C.V.
Agustin M. Chavez No. 1, PB oficina 004
Col. Centro de Ciudad Santa Fe
01210 Mexico, D.F.
Website: www.nilfisk.com

NEW ZEALAND

Nilfisk-Advance
Danish House
6 Rockridge Avenue
Penrose, Auckland 1135
Website: www.nilfisk.com

NORWAY

Nilfisk-Advance AS
Bjørnerudveien 24
1266 Oslo
Tel.: (+47) 22 75 17 70
E-mail: info.no@nilfisk.com

POLAND

Nilfisk-Advance Sp. Z.O.O.
ul. 3 Maja 8
05-800 Pruszków
Website: www.nilfisk.pl

PORTUGAL

Nilfisk-Advance
Sintra Business Park
Zona Industrial Da Abrunheira
Edificio 1, 1° A
P2710-089 Sintra
Website: www.nilfisk.pt

RUSSIA

Нилфиск-Эдванс
127015 Москва
Вятская ул. 27, стр. 7
Россия
Website: www.nilfisk.ru

SOUTH AFRICA

WAP South Africa
12 Newton Street
Spartan 1630
Website: www.nilfisk.com

SOUTH KOREA

Nilfisk-Advance Korea
3F Duksoo B/D, 317-15
Sungsoo-Dong 2Ga, Sungdong-Gu
Seoul
Website: www.nilfisk.com

SPAIN

Nilfisk-Advance S.A.
Torre d'Ara, Planta 9
08302 Mataró
Barcelona
Website: www.nilfisk.es

SWEDEN

Nilfisk-Advance AB
Taljegårdsgatan 4
431 53 Mölndal
Website: www.nilfisk-alto.se

SWITZERLAND

Nilfisk-Advance
Ringstrasse 19
Kircheberg/Industri Stelzl
9500 Wil
Website: www.nilfisk-alto.ch

TAIWAN

Nilfisk-Advance Taiwan Branch
1F, No. 193, sec. 2, Xing Long Rd.
Taipei
Tel.: (+88) 6227 002 268
Website: www.nilfisk-alto.tw

THAILAND

Nilfisk-Advance Co. Ltd.
89 Soi Chochechai-Ruammitr
Viphavadee-Rangsit Road
Ladyao, Jatuchak, Bangkok 10900
Website: www.nilfisk-thailand.com

TURKEY

Nilfisk-Advance A.S.
Serifali Mh. Bayraktar Bulv. Sehit Sk. No:7
Ümraniye
Istanbul
Website: www.nilfisk.com

UNITED KINGDOM

Nilfisk (A Division of Nilfisk-Advance Ltd.)
Bowerbank Way
Gilwilly Industrial Estate, Penrith
Cumbria CA11 9BQ
Tel: 01768 868995
Website: www.nilfisk.co.uk

UNITED ARAB EMIRATES

Nilfisk-Advance Middle East Branch
SAIF-Zone
P.O. Box 122298
Sharjah
Website: www.nilfisk.com

VIETNAM

Nilfisk-Advance Representative Office
No. 51 Doc Ngu Str.
Ba Dinh Dist.
Hanoi
Website: www.nilfisk.com