



# INSTRUCTION MANUAL

# 1500W ELECTRIC 4 TON LOG SPLITTER

Model No: THLS-4 -- Product No: 193892002

ASSEMBLY REQUIRED  
SAVE THESE INSTRUCTIONS  
SPARES & SUPPORT: 01793 333212

Please read & understand this manual, paying attention to the safety instructions, before use.

The manufacturer reserves the right to change the product specification and livery according to continued product improvements.

All images used are for illustration purposes only.



# CONTENTS

- SPECIFICATIONS
- IMPORTANT INFORMATION
- GENERAL SAFETY INSTRUCTIONS
- SET UP & PREPARATION FOR OPERATION
- WIRING & HYDRAULIC DIAGRAMS
- OPERATION
- CHECKING & REPLACING HYDRAULIC OIL
- TROUBLE SHOOTING
- MAINTENANCE & STORAGE
- EC DECLARATION OF CONFORMITY
- PARTS LISTS & DIAGRAM
- WARRANTY

If you require any assistance with regards to the contents or operation of your machine, please contact us:

- **Tel: 01793 333212 - Mon to Friday 8.00am to 5.30pm (excl. Bank Holidays)**
- **Email: [customerservice@handydistribution.co.uk](mailto:customerservice@handydistribution.co.uk)**

## SPECIFICATIONS

The manufacturer reserves the right to change the product specification and livery according to continued product improvements.

<b>Model Number</b>	<b>THLS-4</b>
<b>Product Number</b>	<b>193892002</b>
<b>Motor</b>	230V~ 50Hz 1500W IP54
<b>Splitting Force</b>	4 Ton
<b>Forward Speed</b>	3.8cm/s
<b>Retract Speed</b>	8cm/s
<b>Hydraulic Pressure</b>	16Mpa
<b>Hydraulic Oil Tank Capacity</b>	2.4L
<b>Stroke Length (mm)</b>	220
<b>Log Capacity Diameter (mm)*</b>	Min 50 – 250 Max
<b>Log Capacity Length (mm)</b>	Min 85 – 370 Max
<b>Weight (kg)</b>	38

\* The diameter of the log is not the only factor that determines how easy it will be to split. A small log can be difficult to split when it has knots or is a particularly hard wood.

# IMPORTANT INFORMATION

## HYDRAULIC OIL

This machine is supplied with Hydraulic oil from the factory, to allow the machine to be used straight from the carton. Do check the oil level (instructions available in the manual) prior to the first use and periodically thereafter.

## ELECTRICAL REQUIREMENTS

Connect the main leads to a standard 230V+10% (50Hz+1Hz) electrical supply which has protection devices for under-voltage, over-voltage, over-current as well as a residual current device (RCD) with maximum residual current rated at 0.03A.

## EXTENSIONS LEADS

Improper use of extension leads may cause inefficient operation of the log splitter which can result in overheating. Be sure the extension lead is no longer than 10m and its cross-section is no less than 2.5mm<sup>2</sup> to allow sufficient current flow to the motor. Avoid use of loose or inadequately insulated connections. Connections must be made with a protected material suitable for outdoor use.

## WORKING CONDITIONS









This log splitter is a domestic use model. It is designed for operating under ambient temperatures between +5°C and 40°C and for installation at altitudes no more than 1000m above M.S.L. The surrounding humidity should be less than 50% at 40°C. It can be stored or transported under ambient temperatures between -25°C and 55°C.

## INSPECT YOUR LOG

Make sure there are no nails or foreign objects in logs to be split. The ends of the logs must be cut square. Branches must be cut off entirely so that the trunk is relatively smooth.

# GENERAL SAFETY INSTRUCTIONS

It is important that you read and understand the owner's manual and labels affixed to the machine. Learn its application and limitations as well as the specific potential hazards. Retain these instructions for future reference. The operator is responsible for following the warnings & instructions in this manual and on the product.

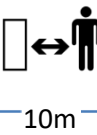
	<p>Read &amp; understand operator's manual before using the machine. Failure to follow instructions could result in death or serious injury.</p>		<p>Always pay full attention to the movement of the log pusher. Do not attempt to load the log on until the log pusher has stopped. Keep hands out of the way of all moving parts.</p>
	<p>Wear gloves to protect your hands</p>		<p>Keep your hands away from splits and cracks which open in the log. They may close suddenly and crush your hands. Do not remove jammed logs with your hands</p>
	<p>Whenever the machine is in use, safety glasses must be worn to safeguard against flying objects. Hearing protection must also be used to protect the operators hearing. If the operator is working in an area where there is a risk of falling objects, a safety helmet must also be worn.</p>		<p>Unplug when not in use, before making adjustments, changing parts, cleaning, or working on the log splitter. Consult the technical manual before servicing.</p>
	<p>Wear foot protection</p>		<p>Take used oil to an authorized collection point or follow the local stipulations that apply where the log splitter is being used. Do not discharge into drains, soil or water.</p>
	<p>Check your log splitter before turning it on. Keep guards in place and in working order. Frequently check to see that keys and adjusting wrenches are removed from the tool area before turning it on. Replace damaged, missing or failed parts before using it.</p>		<p>Keep all bystanders &amp; animals at least 10 metres away from the machine during operation. If approached, stop the machine immediately.</p>



Safety alert symbol. Used to alert you to potential personal injury hazards. Obey all safety messages that follow this symbol to avoid possible injury.



**DANGER**

Indicates an imminently hazardous situation which, if not avoided, will result in serious injury.



**WARNING**

Indicates a potentially hazardous situation which, if not avoided, could result in serious injury



**CAUTION**

Indicates a potentially hazardous situation which, if not avoided, may result in minor or moderate injury.

## CAUTION

Used without the safety alert symbol indicates a potentially hazardous situation which, if not avoided, may result in property damage.

### **STAY ALERT**

Do not operate the machine while under the influence of drugs, alcohol, or any medication that could affect your ability to use it properly. Do not use this machine when you are tired or distracted from the job at hand. Be aware of what you are doing at all times. Use common sense.

### **AVOID DANGEROUS CONDITIONS**

Make sure there is adequate surrounding workspace. Cluttered areas invite injuries. Keep your work area clean with sufficient light. Keep the area around the machine clear of obstructions, grease, oil, rubbish and other debris which could cause persons to fall onto moving parts.

### **INSPECT YOUR MACHINE**

Check all bolts, nuts, and screws for tightness before each use, especially those securing guards and drive mechanisms. Vibration during use, may cause these to loosen.

Form a habit of checking to see that all other tools/equipment are removed from the working area before turning it on.

Replace damaged, missing or failed parts before using it. Warning labels carry important information. Replace any missing or damaged warning labels.

### **DRESS PROPERLY**

Do not wear loose clothing, gloves, scarfs, neckties or jewelry (rings, wrist watches), which can be caught in moving parts. Protective electrically non-conductive gloves and non-skid heavy duty footwear are highly recommended when working. Wear a face or dust mask if the operation is dusty. Always wear safety glasses/goggles and/or face shields. Everyday eyeglasses have only impact resistant lenses; they are not safety glasses/goggles. Wear protective hair covering to contain long hair, preventing it from getting caught in machinery.

### **AVOID ELECTRICAL SHOCK**

Check that the electric circuit is adequately protected and that it corresponds with the power, voltage and frequency of the motor. Check that there is a ground connection, and a regulation differential switch further up the circuit. Ground the log splitter. Prevent body contact with grounded surfaces: pipes, radiators, ranges, and refrigerator enclosures. Never open the pushbutton box on the motor. Should this be necessary, contact a qualified electrician. Make sure your fingers do not touch the plug's metal prongs when plugging or unplugging the log splitter.

### **KEEP BYSTANDERS AND CHILDREN AWAY**

Keep unauthorised persons a minimum distance of 10 metres away from the machine. If approached, stop the machine immediately. Do not allow children to handle, climb on or in the machine.

### **DO NOT OVERREACH**

Keep proper footing and balance at all times when using the machine. Never stand on the machine. Serious injury could occur if the machine is tipped or if the moving parts are unintentionally contacted. Do not store anything above or near the machine, where anyone might stand on the machine to reach them.

### **AVOID INJURY FROM UNEXPECTED ACCIDENT**

Keep hands & feet out of the way of all moving parts. Do not place any part of your body or any tool e.g. in the machine during operation.

### **DO NOT FORCE TOOL**

Always work within the rated capacity. Do not use the machine for a purpose for which it was not intended.

### **NEVER LEAVE MACHINE RUNNING UNATTENDED**

Do not leave the machine unattended until it has come to a complete stop.

### **MAINTAIN YOUR MACHINE WITH CARE**

Clean the machine immediately after use. Keep the machine clean to ensure it operates to its full & safest performance. When maintaining this machine, only the manufacturer's original replacement parts should be used. The use of non-original manufacturer parts may invalidate your warranty.

**PROTECT THE ENVIRONMENT**

Take left over materials to an authorised collection point or follow the stipulations in the country where the machine is used. Do not discharge into drains, soil or water.

**STORE IDLE EQUIPMENT**

When not in use, the machine should be stored in a dry location. Keep the machine away from children and others not qualified to use it.



This symbol on the product or on its packaging indicates that this product may not be treated as household waste. Instead it shall be handed over to the applicable collection point for the recycling of electrical and electronic equipment.

For more detailed information about recycling of this product, please contact your local council office, your household waste disposal service or shop where you purchased the product.

# SET UP & PREPARATION FOR OPERATION

Familiarise yourself with the controls and features of this log splitter in the illustrations.

1. Log Pusher
2. Work Table
3. Wedge
4. Handle
5. Support Leg
6. Log Retaining Plates
7. Switch
8. Motor
9. Electric Motor Switch Case
10. Wheels (short distances ONLY).
11. Hydraulic Control Lever
12. Control Lever Guard
13. Bleed Screw
14. Oil Drain Bolt w/ Dipstick
15. Max Pressure Limiting Screw

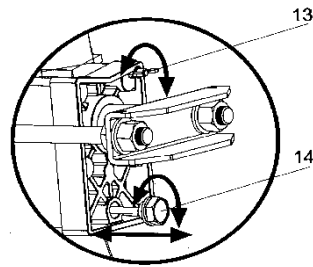
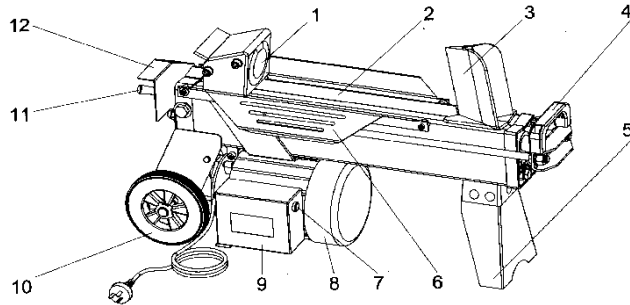

## BLEED SCREW

### IMPORTANT

Before operating the log splitter, the Bleed Screw should be loosened a few rotations until air can go in and out of the oil tank smoothly. Air flow through the Bleed Screw hole should be noticeable while the log splitter is working. Before moving the log splitter, make sure the Bleed Screw is tightened to avoid oil leaks.



***FAILURE TO LOOSEN THE BLEED SCREW WILL KEEP THE SEALED AIR IN HYDRAULIC SYSTEM COMPRESSED. SUCH CONTINUOUS AIR COMPRESSION WILL BLOW OUT THE SEALS OF THE HYDRAULIC SYSTEM AND CAN CAUSE PERMANENT DAMAGE TO THE LOG SPLITTER, WHICH IS NOT COVERED UNDER THE TERMS & CONDITIONS OF THE MANUFACTURERS WARRANTY.***



# MAX PRESSURE LIMITING SCREW

## DO NOT ADJUST

The max pressure was set by the manufacturer. The max pressure limiting screw is sealed with glue to ensure the log splitter works under pressure no more than is listed in the specifications. The setting was made by a qualified mechanic with professional instruments. Unauthorised resetting will reduce the performance of the hydraulic pump or **RESULT IN SERIOUS INJURY AS WELL AS DAMAGE TO THE MACHINE.**

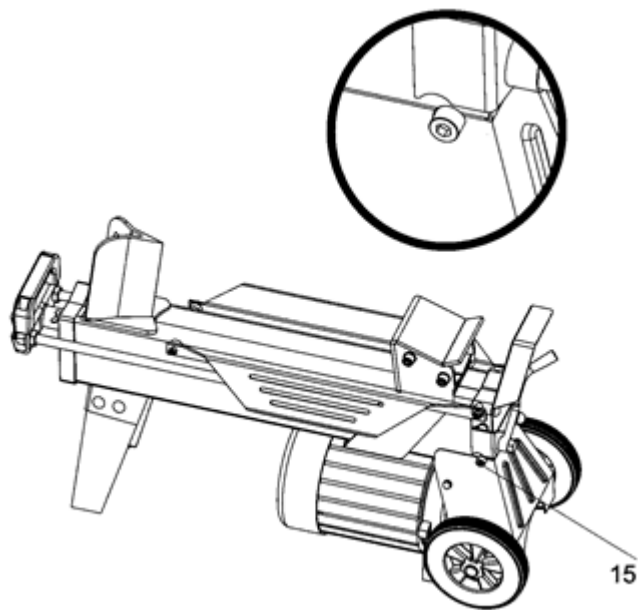

## WIRING DIAGRAM

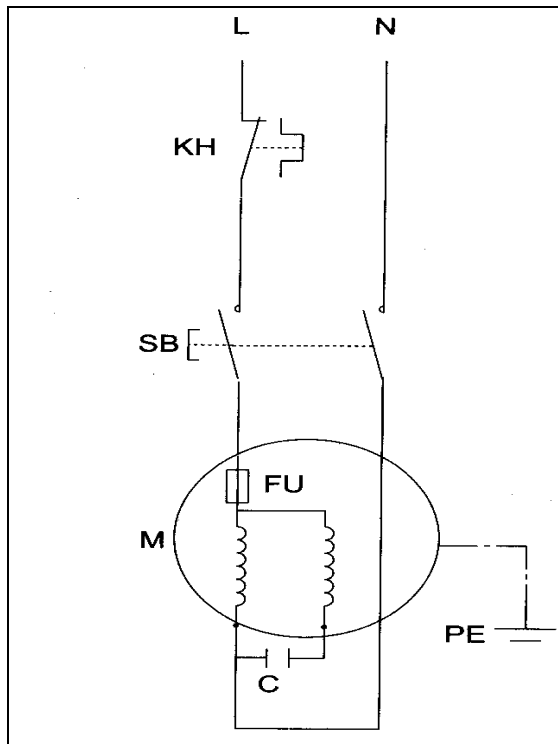

## HYDRAULIC DIAGRAM

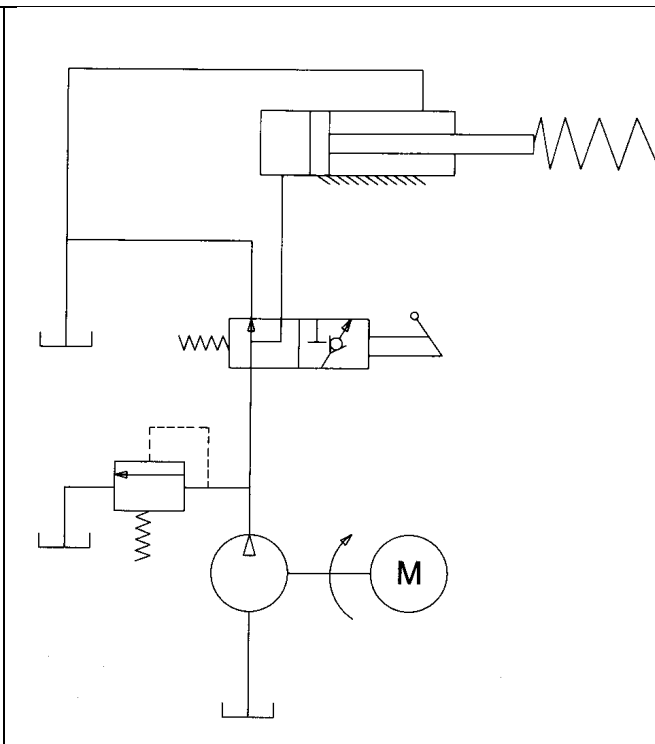

## OPERATION

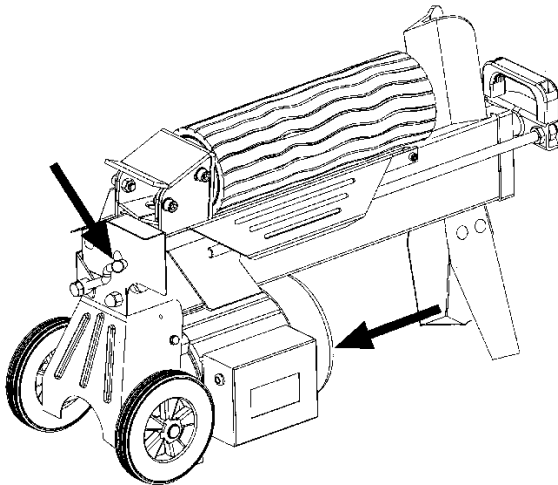

This log splitter is equipped with “ZHB” control system that must be operated with both hands – the left hand controls the hydraulic control lever while right hand controls the pushbutton switch. The log splitter will freeze if either hand is removed. The log pusher will only start to return backwards to the starting position after both hands release the controls. During use the log pusher will move towards the splitting wedge putting pressure on the log.

The trigger type lockout device is used to avoid accidental Hydraulic Control Lever activation. To operate the Hydraulic Control Lever, draw the Trigger backward with your index finger before pushing the Hydraulic Control Lever forward.



**Never force the log splitter for more than 5 seconds. Do not keep pressure on it to split excessively hard wood.**

After 5 seconds of constant use, the oil under pressure will be overheated and the machine could be damaged. For such extremely hard logs, rotate it by 90° to see whether it can be split in a different direction (the log should still be split with the grain as shown in the diagrams in this manual). In any case, if you are not able to split the log, this means that its hardness exceeds the capacity of the machine and thus that log should be discarded to protect the log splitter.

**Always set logs firmly on the log retaining plates and work table. Make sure that the log will not twist, rock or slip while being split. Do not force the blade by splitting the log on the upper part of the wedge (as shown in the diagram). This will break the blade or damage the machine.**

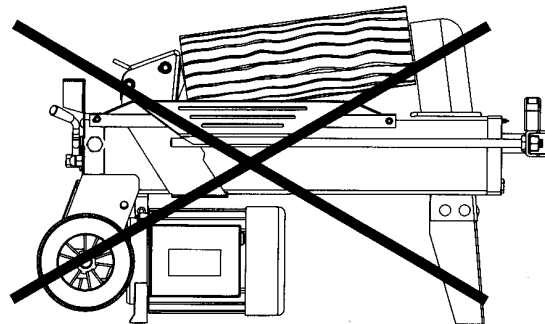

Break the log in the direction of its growing grain. Do not place log across the log splitter for splitting. It may be dangerous and may seriously damage the machine.

Do not attempt to split 2 pieces of logs at the same time. One of them may be thrown by the machine which could cause serious injuries to the user.

## FREEING A JAMMED LOG

- Release both controls.
- After the log pusher moves back and completely stops at its starting position, insert a wedge of wood under the jammed log.
- Start the log splitter to push the wedge wood to go completely under the jammed one.
- Repeat above procedure with sharper sloped wedges of wood until the log is completely freed.

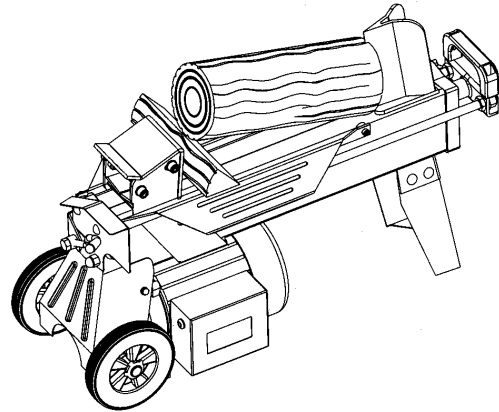

### DANGER

Do not try to knock the jammed log off.  
This will damage the machine or may  
launch the log and cause serious injuries.

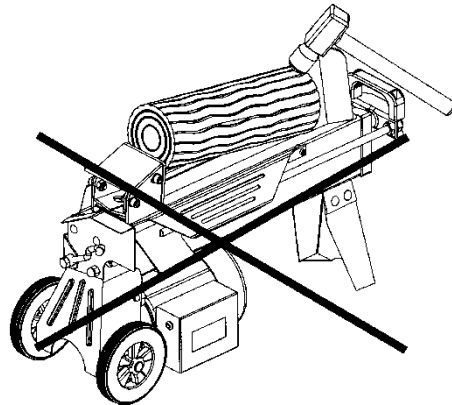

## SHARPENING THE SPLITTING WEDGE

After using the log splitter for some time, sharpen the splitting wedge using a fine-toothed file and smooth any burrs or crushed areas along the cutting edge.

## RAM ADJUSTMENT

The Handy 4 Ton Log Splitter is fitted with a Ram Adjustment Knob which reduces any unnecessary movement of the ram, allowing for quicker and more efficient use of the tool.

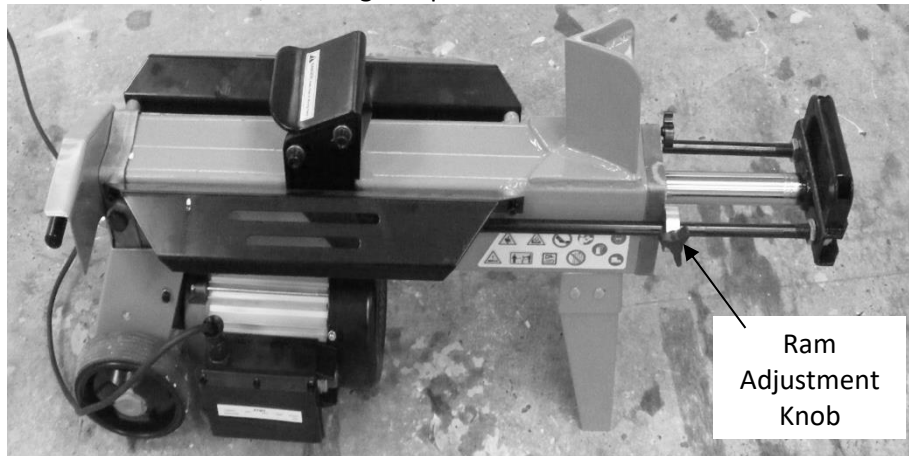

### WARNING

**When adjusting the ram movement, do not put your hands between the hand knob and the log splitter mechanism, as accidental release of the Control Handle would cause the returning hand knob and handle to trap and crush your hand against the splitter.**

- To adjust the ram movement, first undo the hand knob.
- Then without a log on the work table depress the Control Handle and the start button.
- When the gap between the ram and the splitting wedge is the intended size, release the start button, but continue to hold the Control Handle to keep the ram in place.
- Slide the hand knob along the pipe to set the gap size. The closer you move the Ram Adjustment Knob towards the log splitter, and the more you slide it down the pipe, the smaller the gap will be left between the ram and the splitting wedge.
- If the gap is correct you should place the hand knob against the log splitter.
- If the gap is too small you can leave an equivalent space between the knob and the log splitter so that the ram returns further back.
- If the gap is too small, you must press the start button to reduce it before setting the Ram Adjustment Knob.
- Once you have set the hand knob at the desired position, retighten it to adjust the movement of the ram.
- Make sure that your hand is clear of the hand knob area. You can now release the Control Handle. The ram should now return to the desired position whenever you release the start button and Control Handle. You can repeat these steps if further adjustment is required.



# CHECKING & REPLACING HYDRAULIC OIL

The log splitter is supplied with a full hydraulic oil tank; however, you should check if hydraulic oil needs to be added, in case of leakage during transit, prior to your first operation.

You should also replace the hydraulic oil in the log splitter after every **150 hours** of use.

Periodically check the oil level to ensure it is between the 2 grooves around the Dipstick. To check the oil.

- Stand the machine up at the wheel end.
- Release the Dipstick located on the end of the machine with an 8mm Allen Key.
- If the oil level is lower than the bottom mark on the Dipstick and refill the oil.
- The oil level should be between the 2 grooves.

Follow the steps below to check and replace hydraulic oil.

- Make sure all moving parts stop and the log splitter is unplugged.
- Using an 8mm Allen Key, unscrew the Dipstick & remove it.
- Tip the log splitter onto the Support Leg side over a minimum 4 litre capacity container to drain the hydraulic oil off.
- Tip the log splitter on the motor side.
- Refill with fresh hydraulic oil as per the hydraulic oil capacity indicated in the specifications.
- Clean the Dipstick and put it back into the oil tank while keeping the log splitter held upright.
- Make sure the level of the refilled oil is just between the 2 grooves around the Dipstick.
- Clean the Oil Drain Bolt before replacing it. Make sure they are tightened to avoid leaks before lowering the log splitter back to a horizontal position.

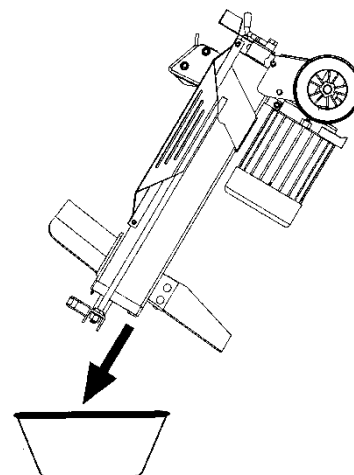
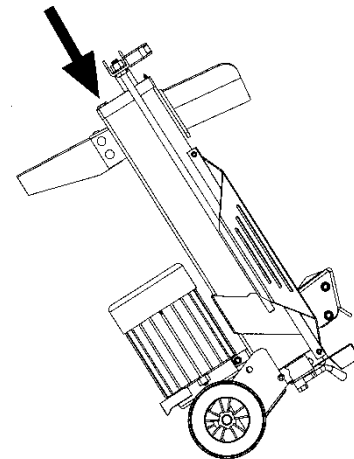

**The following hydraulic oils or equivalent are recommend for the log splitter's hydraulic transmission system:**

**HANDY PARTS Log Splitter Oil WPL110 (1 Litre), WPL113 (5 Litre)**

**SHELL Tellus 22**

**MOBIL DTE 11**

**ARAL Vitam GF 22**

**BP Energol HLP-HM 22**

HYDRAULIC OIL	THLS-6
Total capacity	4.0 Litres
Max amount of oil needed to reach top mark of dipstick	2.75 Litres
Min amount of oil needed to reach lower mark of dipstick	2.4 Litres

# TROUBLE SHOOTING

PROBLEM	PROBABLE CAUSE	REMEDY SUGGESTED
Motor running, ram not moving	Incorrect specification extension lead	Be sure the extension lead is no longer than 10m and its cross-section is no less than 2.5mm <sup>2</sup> to allow sufficient current flow to the motor.
Fails to split logs	Log is improperly positioned	Refer to the "Operation" section for log loading instructions.
	The sizes or hardness of the log exceeds the capacity of the machine	Reduce the log size before splitting it
	Splitting wedge is blunt	Refer to "Sharpening Splitting Wedge" section to sharpen the cutting edge.
	Oil leak	Locate leak & contact local Approved Dealer
	Unauthorised adjustment was made on Max. Pressure Limiting Screw. Lower max pressure rating was set.	Contact local Approved Dealer.
The log pusher moves jerkily, making unfamiliar noises or vibrating excessively	Lack of hydraulic oil	Check oil level for possible oil refilling.
	Excessive air in the hydraulic system.	Remove the bleed screw. Operate the ram 5 or 6 times without a log in place. Return the bleed screw to open position and split the log. If the problem continues contact the local Approved Dealer.
Oil leaks around the cylinder ram or from other points.	Air sealed in the hydraulic system while operating.	Loosen the Bleed Screw by 2 - 3 rotations to open position, do not remove, before operating the log splitter
	Bleed Screw was not tightened before moving the log splitter.	Tighten the Bleed Screw after use and before moving.
	The Oil Drain Bolt with Dipstick is not tight.	Tighten the Oil Drain Bolt with Dipstick with 8mm Allen Key.
	The Hydraulic Control Valve Assembly and / or seal(s) are worn	Contact the local Approved Dealer

## MAINTENANCE & STORAGE

Always ensure the Bleed Screw is fully tightened when the machine is not in use.

When not in use, the machine should be stored in a dry location. Keep the machine away from children and others not qualified to use it. Avoid direct sunlight.

Do not store anything above or near the machine, where anyone might stand on the machine to reach them.



## EC DECLARATION OF CONFORMITY

We Handy Distribution Ltd - SN3 5HY (Importer) declare that the product:

**Designation:** 1500w Electric 4 Ton Log Splitter

**Model(s):** THLS-4

**Product No.** 193892002

**Type/Serial No.** As per rating label on machine

**Complies with the following directives:**

2006/42/EC - Machinery Directive

2006/95/EC - Low Voltage Directive

**The conformity assessment procedure followed was in accordance with**

EN609-1:1999+A1:03+A2:09, EN60204-1, EN 954-1:1996, 6.2.2,

EN982, EN 292-2:1991, 5.5 EN ISO 4413:2010,

**Notified Body:**

TUV Rheinland / CCIC (Qingdao) Co., Ltd.

**Addresses:**

6F, No.2 Bldg, No.175 Zhuzhou Rd., Qingdao 266101, P. R. China

Tillystrasse 2, 90431 Nurnberg, GERMANY

**Authorised signatory & technical file holder**

**Date:**

01/11/2016

**Signature:**

A handwritten signature in black ink, appearing to read 'S Belcher', written over a horizontal line.

**Name:**

Mr. Simon Belcher

**Position:**

Managing Director

**Company:**

Handy Distribution Ltd

**Address:**

Murdock Rd, Dorcan, Swindon, Wiltshire, SN3 5HY.

# PARTS DIAGRAM – THLS-4 (193892002)

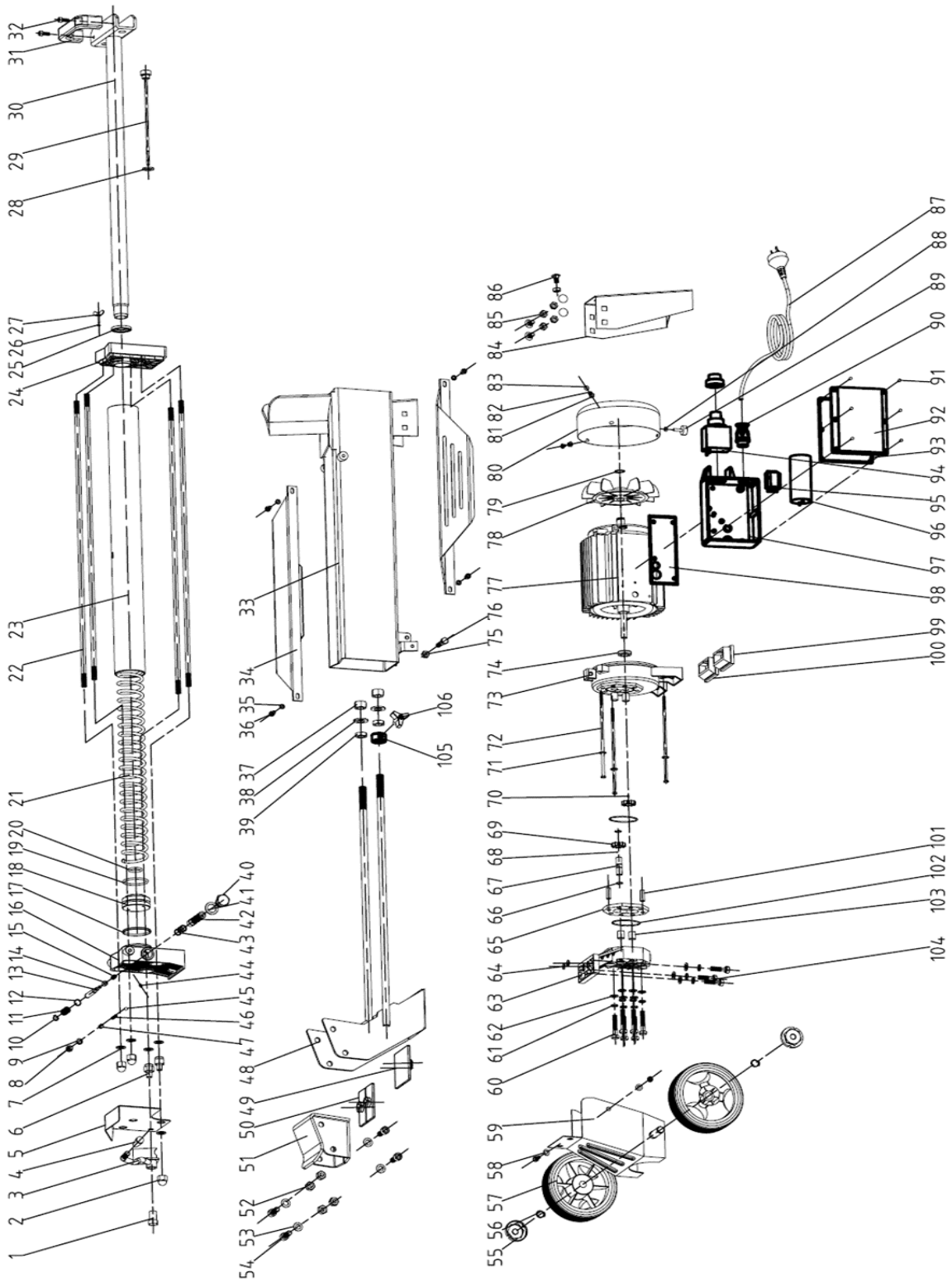



# PARTS DIAGRAM – THLS-4 (193892002)

No	Part No	Description	Qty	No	Part No	Description	Qty	No	Part No	Description	Qty
1	TH114-38	Lever Mount Nut	1	37	TH114-11	Nut	2	73	TH114-71	Motor Cover	1
2	TH114-33	Nut Cap	3	38	TH114-8	Flat Washer	2	74	TH114-57	Seal	1
3	TH114-36	Lever	1	39	TH114-7	Nut	2	75	TH114-54	Nut	1
4	TH114-37	Lever Knob	1	40	TH114-51	Valve Plug	1	76	TH114-55	Screw	1
5	TH114-34	Guard Plate	1	41	TH114-50	Washer	1	77	TH186-65	Motor	1
6	TH114-35	Nut	2	42	TH155-42	Valve Sleeve	1	78	TH155-78	Fan	1
7	TH114-28	Copper Gasket	4	43	TH155-43	Spring	5	79	TH155-79	Block Turn	1
8	TH155-8	Screw	1	44	TH155-44	Adjusting Screw	1	80	TH155-80	Shroud	1
9	TH155-9	O-ring	1	45	TH114-40	Steel Ball	1	81	TH155-81	Flat Washer	2
10	TH155-10	Snap Washer – Shaft	1	46	TH114-29	Pressure Valve Spring	1	82	TH155-82	Spring Washer	3
11	TH155-11	Valve Retract Spring	1	47	TH114-30	Adjusting Screw	1	83	TH155-83	Screw	2
12	TH114-32	O-ring	1	48	TH186-53	Log Pusher Weldment	1	84	TH114-59GM	Support Leg	1
13	TH114-43	Valve Core Rod	1	49	TH114-52	Plastic Insert 1	1	85	TH155-85	Nut	5
14	TH155-14	Sliding Pressure Sensor Sleeve	1	50	TH114-23	Plastic Insert 2	1	86	TH114-60	Bolt	5
15	TH155-15	Sliding Pressure Sensor Sleeve Spring	1	51	TH114-24	Log Pusher	1	87	TH114-65	Cable & plug	1
16	TH186-27	Aluminium Cover ( Rear )	1	52	TH114-25	Nut	4	88	TH114-66	Motor Foot Nut	3
17	TH186-26	O-ring	1	53	TH114-22	Flat Wahser	5	89	TH114-67	Motor Foot	1
18	TH186-3	Piston	1	54	TH114-21	Screw	4	90	TH114-90	Electrical cable Housing	1
19	TH186-2	Piston Ring	1	55	TH114-88GM	Wheel cover	2	91	TH114-91	Screw	11
20	TH114-4	O-ring	1	56	TH114-89	Block turn	2	92	TH114-92	Switch Box cover	1
21	TH186-5	Spring	1	57	TH114-90	Wheel	2	93	TH114-93	Airproof underlay	1
22	TH186-15	Stud	4	58	TH155-58	Washer	2	94	TH114-94	Switch	1
23	TH186-1	Hydraulic Cylinder	1	59	TH114-39GM	Wheel shelf	1	95	TH114-95	Connection Terminal	1
24	TH186-61	Aluminium Cover ( Front)	1	60	TH114-87	Bolt	6	96	TH114-96	Capacitor	1
25	TH114-12	Piston Rod Seal	1	61	TH155-61	Spring Washer	9	97	TH114-97	Switch Box	1
26	TH114-14	O-ring	1	62	TH155-62	Washer	9	98	TH114-98	Waterproof underlay	1
27	TH114-13	Bleed Screw	1	63	TH114-83	Gear Pump Cover	1	99	TH114-73	Motor Support Left Shoe	1
28	TH114-62	Washer Groupware	1	64	TH144-64	Spring	2	100	TH114-72	Motor Support Right Shoe	1
29	TH186-63	Dipstick	1	65	TH186-76	Gear Housing Plate	1	101	TH114-75	Pin	2
30	TH186-6	Piston Rod	1	66	TH114-79	Circlip	2	102	TH114-82	Spring	2
31	TH114-9	Lift Handle	1	67	TH186-80	Gear Shaft	1	103	TH114-81	Sliding Sleeve	4
32	TH114-10	Screw	2	68	TH114-78	Steel Ball	1	104	TH114-84	Bolt	3
33	TH186-20GM	Frame Tube	1	69	TH186-77	Gear	2	105	TH114-105	Ram Stopper	1
34	TH186-19	Lead plank	2	70	TH155-70	Pin	1	106	TH114-106	Ram Stopper 3-star screw	1
35	TH114-17	Spring Washer	4	71	TH114-69	Washer	6				
36	TH114-16	Screw	6	72	TH114-70	Bolt	3				

# GJ HANDY & CO LTD USER WARRANTY POLICY

## **Users Statement of Warranty**

Each new machine is warranted against defective material or assembly of material under normal usage. The warranty applies to the original purchaser and covers faulty parts and the labour involved in replacing and repairing those parts, which are of original manufacture.

## **Period of Warranty**

### **All Webb & Webb Pro machines plus Sanli engines.**

- a) 2 years from the original date of sale to the first domestic user.
- b) 90 days from the original date of sale to the professional/commercial user.
- c) 90 days from the original date of sale when used for hire.
- d) A reduced warranty period of 90 days applies to those items which are subject to normal wear and tear (e.g. but not limited to wheels, tyres, cutter bars, cylinders, bottom blades, belts, cables, grass bags, spark plugs).
- e) Engines as per the manufacturer's warranty statement which will be supplied with the machine.
- f) 90 days from the original date of purchase for Replacement Spare Parts (unless normal wear & tear component, which are covered for 30 days).
- g) All machines' must be serviced within the first 12 months from the original date of purchase to comply with the warranty, failure to do so will invalidate the 2nd year of the warranty.

### **All Handy, Mowerland and Q-Garden products.**

- a) 1 year from the original date of sale to the first domestic user.
- b) 90 days from the original date of sale to the professional/commercial user.
- c) 90 days from the original date of sale when used for hire.
- d) A reduced warranty period of 90 days applies to those items which are subject to normal wear and tear (e.g. but not limited to wheels, tyres, cutter bars, cylinders, bottom blades, belts, cables, collection bags, spark plugs).
- e) Engines as per the manufacturer's warranty statement which will be supplied with the machine.
- f) 90 days from the original date of purchase for Replacement Spare Parts (unless normal wear & tear component, which are covered for 30 days).

All warranty repairs must be undertaken by an authorised service dealer. These dealers have been accredited by GJ Handy & Co Ltd and agree to only use genuine parts and follow our repair procedures.

# GJ HANDY & CO LTD USER WARRANTY POLICY

## **Not covered by this warranty**

- a) The warranty policy does not cover any depreciation or damages caused by ordinary wear, rusting or corrosion, lack of correct maintenance or operation, misuse, abuse, lack of transportation or accident.
- b) The warranty policy does not cover any costs necessary for the standard periodic maintenance services instructed by the operator's manual, or service parts replacement which would include oil, filters, tyres, belts, brake linings, fuses, blades, seals and other service parts unless it can be proven that the item has evidence of faulty manufacture.
- c) The warranty policy will not cover failure or damage caused as a result of parts or accessories being modified without the written approval of GJ Handy & Co Ltd.
- d) The warranty policy will not cover the unit if non-genuine parts have been fitted and as a result damage has occurred to the unit.
- e) The warranty policy is non-transferable and is only applicable to the original purchaser.

## **Disclaimer**

- a) This warranty is only a remedy for defect of products. GJ Handy & Co Ltd will never warranty in terms of the merchantability or the fitness for a particular purpose.
- b) No person is authorised to make any warranties, representations or promises, expressed or implied, on behalf of GJ Handy & Co Ltd, or to modify the terms conditions or limitation of this warranty policy in any way.
- c) Neither GJ Handy & Co Ltd nor any company affiliated with GJ Handy & Co Ltd shall be liable in any event or manner whatsoever for incidental or consequential damages or injuries, including, but not limited to, loss of crops, loss of profit, out of pocket expenses or profits, rental of substitute equipment or other commercial losses.

## **General**

- a) Most warrantable failures show up within the first few weeks of use. These failures are usually straightforward and warranty assessment is relatively easy.
- b) Failures relating to cutter decks and belts need careful investigation, as the cause may not always be straightforward. Look for damage to blades and pulleys especially when the cutter belt or blade boss have snapped or cracked as this could be due to impact damage.
- c) Customers should always refer to the operator/instruction manual when any disputed problem arises, you will find most areas covered within the manual.

For spares or support of your handy product,  
please contact us:

Tel: 01793 333212

(Mon – Fri 8.00am to 5.30pm excl. Bank Holidays)

Email: [customerservice@handydistribution.co.uk](mailto:customerservice@handydistribution.co.uk)

**To see our range of garden machinery & equipment visit:**

**[www.thehandy.co.uk](http://www.thehandy.co.uk)**

**Making gardening easier & affordable since 1938**

Distributed by Handy Distribution, Murdock Road, Dorcan, Swindon, SN3 5HY