

Installation Instructions

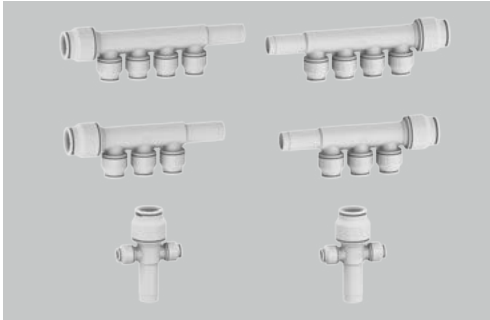

Introducing the new JG Speedfit 2, 3 and 4 port plastic plumbing manifolds. All port sizes are available as a stem or straight through socket design. The Speedfit push-fit connections make for fast and easy installations, even in confined spaces.

Whilst designed as a heating product, the manifolds can also be used in a mains pressure hot or cold domestic plumbing system, to feed bathroom or kitchen taps and mixers. This allows for a more efficient installation as every terminal fitting has its own dedicated supply.

Other benefits include good flow characteristics and even distribution of water.

Stem ended manifolds create additional installation flexibility, allowing for the stem end to be opened to create a straight through 22mm manifold. This is especially useful when connecting a series of manifolds together.

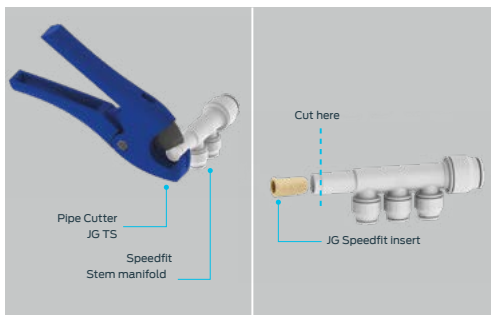

To cut and connect a stem ended manifold, firstly ensure the manifold stem is free of score marks. Cut the stem end square at the cut line indicated in the below diagram.

We recommend the use of JG Speed Pipe Cutters (part code JG-TS) to do this. To prevent damage to the O-Ring, remove all burrs and sharp edges from the cut end.

Once cut, use a Standard Speedfit Pipe Insert (part code TSM22) into the stem connection. Once fully inserted, further connections to additional manifolds or JG Speedfit fittings can commence.